

23402
#28204

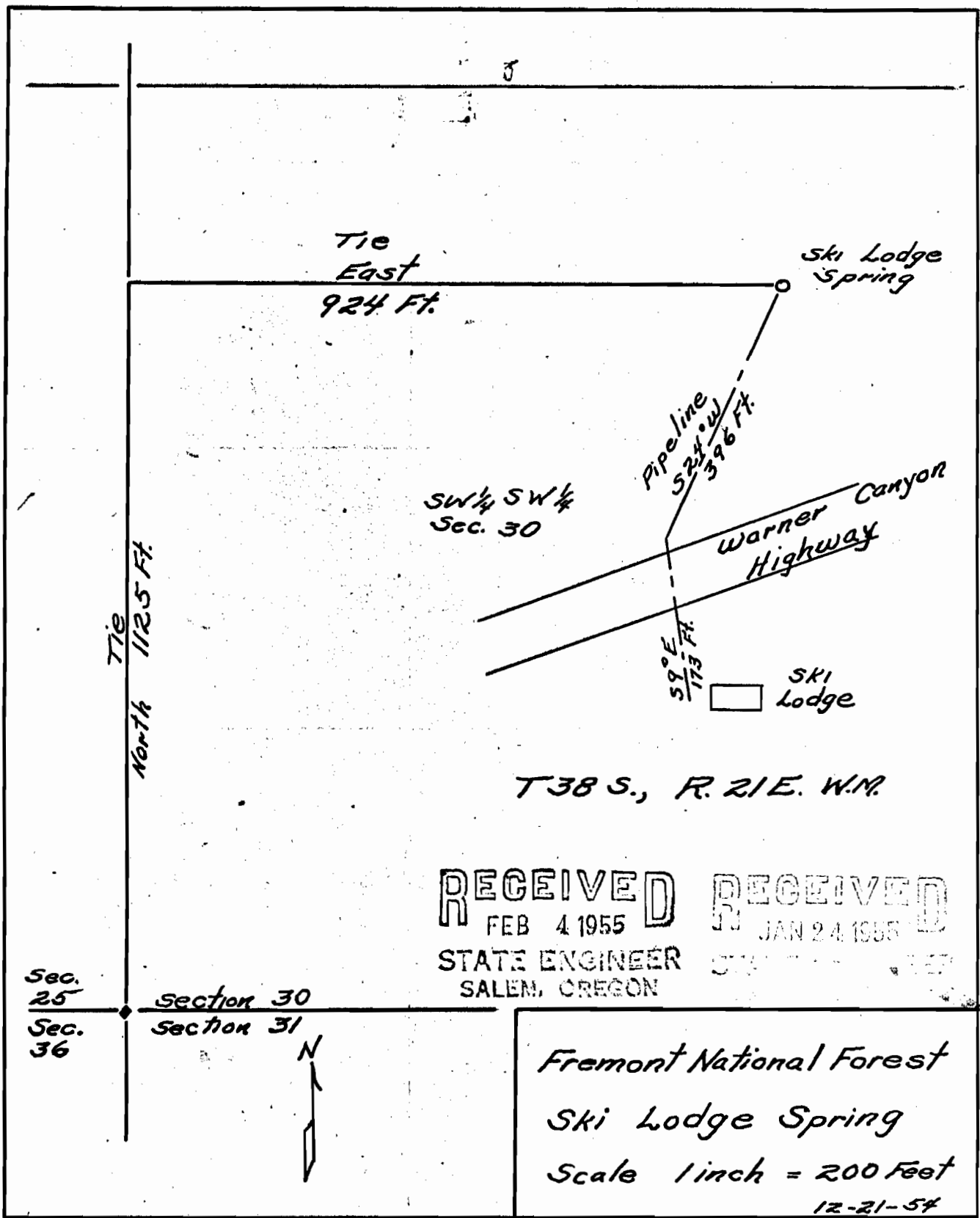

RECEIVED
 FEB 4 1955
 STATE ENGINEER
 SALEM, OREGON

RECEIVED
 JAN 24 1955
 STATE ENGINEER
 SALEM, OREGON

Fremont National Forest
 Ski Lodge Spring
 Scale 1 inch = 200 Feet
 12-21-54

Application No. 29725
 Permit No. 23402
 29725
 38-21 ✓