

T. 30 S.R. 15 W.W.M.

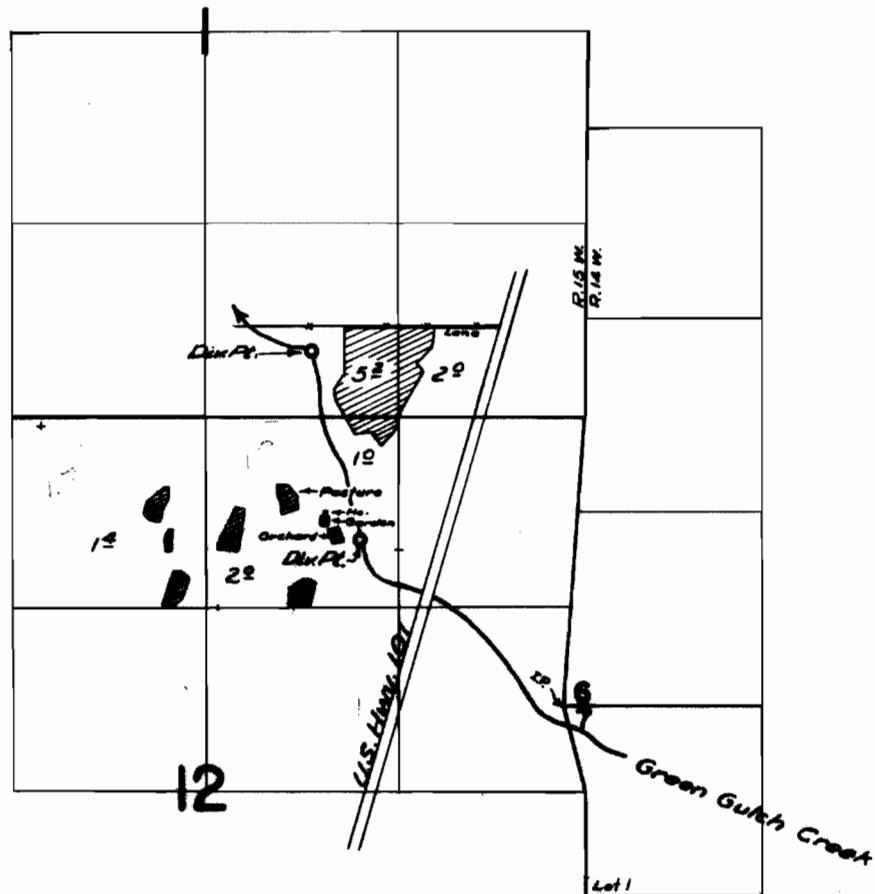

FINAL PROOF SURVEY
UNDER

Application No. 22919 Permit No. 19069

IN NAME OF
ENNIS & VIOLA JANE LOSHBAUGH,
W.A. & MARY E. PANTER, LEANDER A., LELAND T., & CHARLES W. PANTER

Surveyed ^{APRIL 24 1958} JUNE 14 1960, by Mr. [Signature]