

CH 28431

910
1615

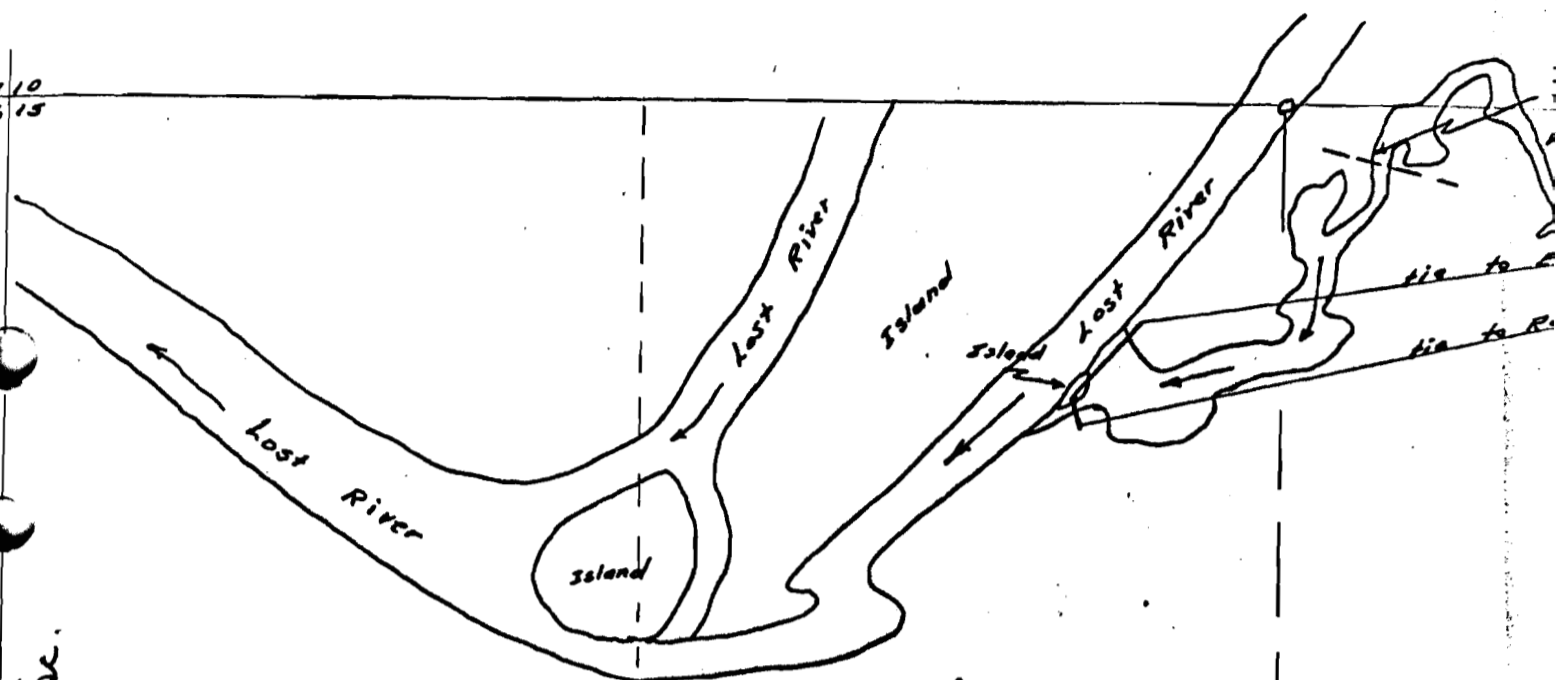

Lost River main.

Appl. R-31552 + 31553
Per. R-2019 + 24901

15

The purpose of this project is to raise water level in the center maximum depth of about 6 ft. for commercial raising of the fill dam of 6 ft. maximum height about 200 ft in length across River and a rock masonry dam 6 ft. high by about 50 ft long the second channel to Lost River as shown. The springs about 12 c.f.s. and the reservoir will store approximately 12 reservoir will be raised no higher than it is during every River is raised by control at Harpold Dam by Harset, loss to the USBR will be practically negligible.

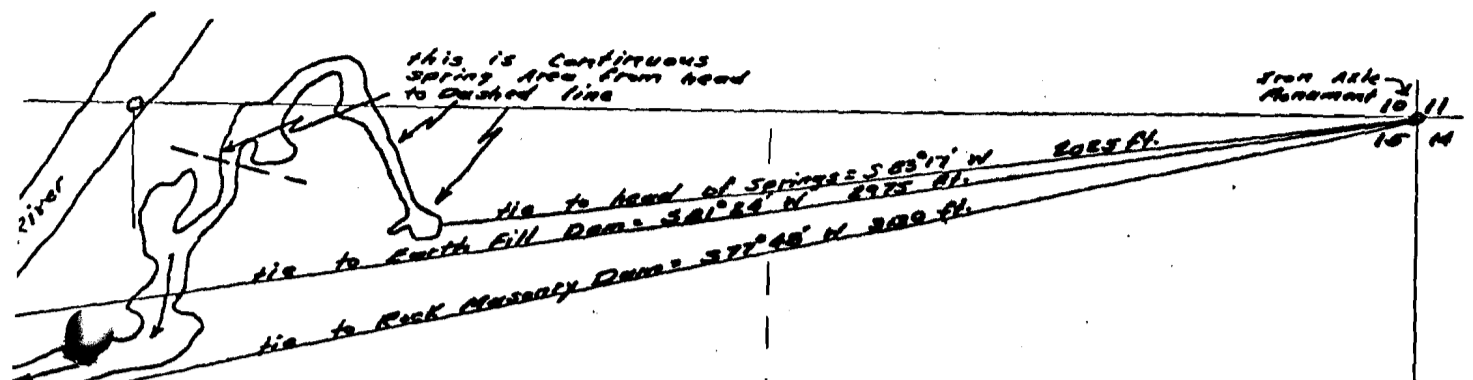

Appl. R-31552 + 31553
 Per. R-2019 ~ 24901

15

Water level in the continuous flowing springs to a
 commercial raising of trout. It will require an earth-
 cut 200 ft in length across the first channel to last
 by about 50 ft long with gates and screen across
 shown. The springs have a continuous flow of
 store approximately 12 acre feet. The water in the
 or it is during every irrigation season when last
 old Dam by Horsefly Irrigation District. Water
 eligible.