

28808

West 1/4 Cor. Sec. 4
T.15 S., R.16 E., W.M.

SCALE
1 INCH = 200 FEET

1311.5'

60'
660'

Point 660' South of
1/4 Cor.

12' Roadway

25 ACRES

MELROSE

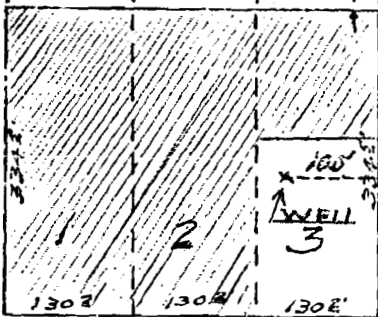

MELROSE DRIVE

ACRES

PAULINA HWY
3345'

Description -

Lot 1 - Beginning at a point 660' S. & 30' E of the West 1/4 Cor. of Sec. 4, T.15 S., R.16 E., W.M. Thence South 334.5', East 130.2', North 334.5' & West 130.2' to point of Beginning.

Lot 2 - Beginning at a point 660' South & 160.2' E of West 1/4 Cor. of Sec. 4, T.15 S., R.16 E., W.M. Thence South 334.5', East 130.2', North 334.5', & West 130.2' to place of beginning.

Lot 3 - Beginning at point 660' South & 420' East of West 1/4 Cor. of Sec. 4, T.15 S., R.16 E., W.M. Thence South 334.5', West 130.2', North 334.5', E 130.2' to place of Beginning.



IRRIGATED

Application No. G-1126
Permit No. G-786