

Per # 4284  
2898 52198

7488

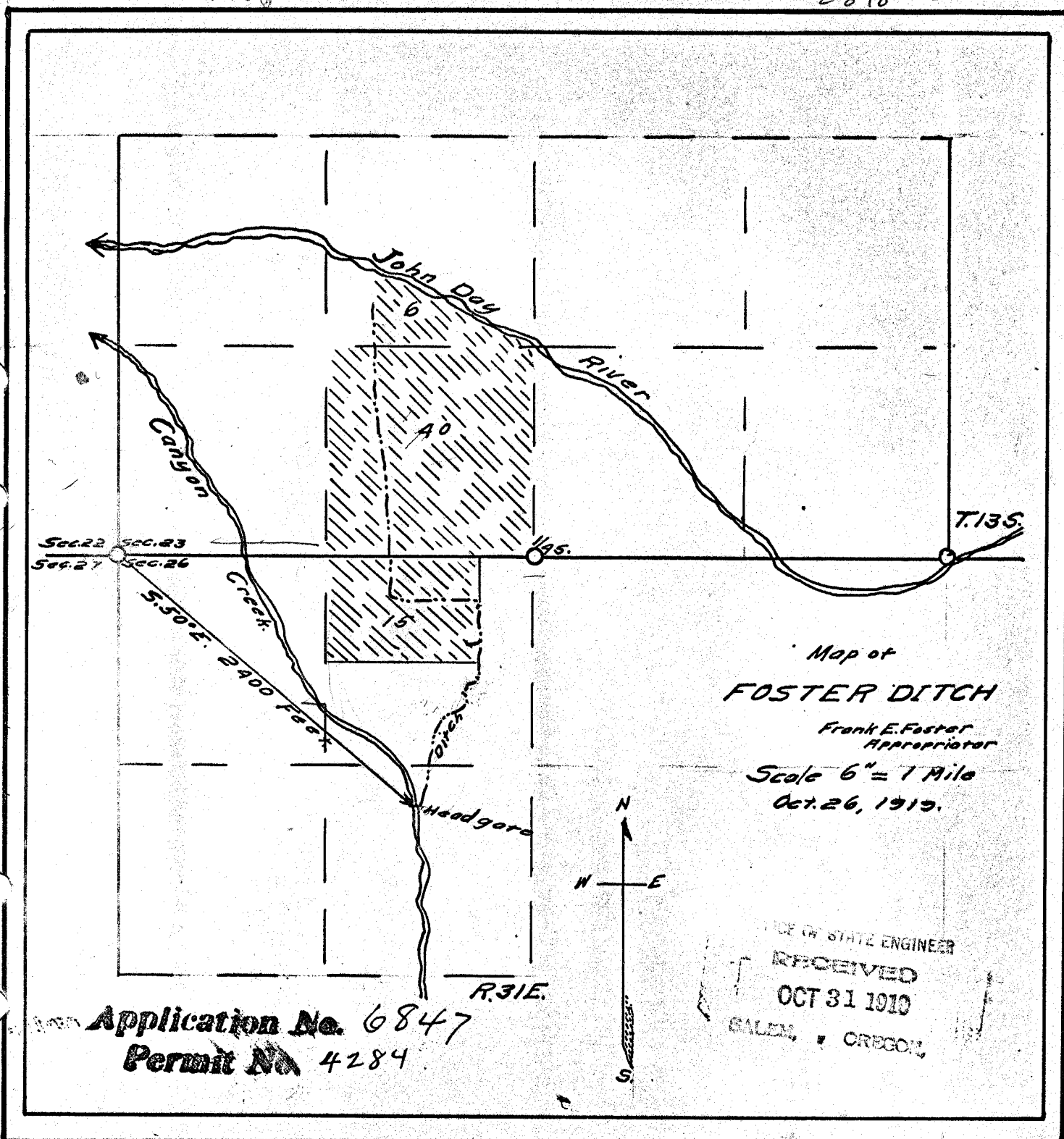

Map of  
**FOSTER DITCH**  
 Frank E. Foster  
 Appropriator  
 Scale 6" = 1 Mile  
 Oct. 26, 1910.

OFFICE OF STATE ENGINEER  
 RECEIVED  
 OCT 31 1910  
 SALEM, OREGON

Application No. 6847  
 Permit No. 4284

BRIS

924