

Twp. 20°30'E

RECEIVED
JUL 25 1945
STATE ENGINEER
SALEM, OREGON

Scale
One inch = 1/4 mile

MAP

To accompany applica-
tion for a Permit to
appropriate Water in
Sec. 28, Twp. 23 S, R
12, W.W.M., Coos
County, Oregon

H.A. Gowman,
Applicant.

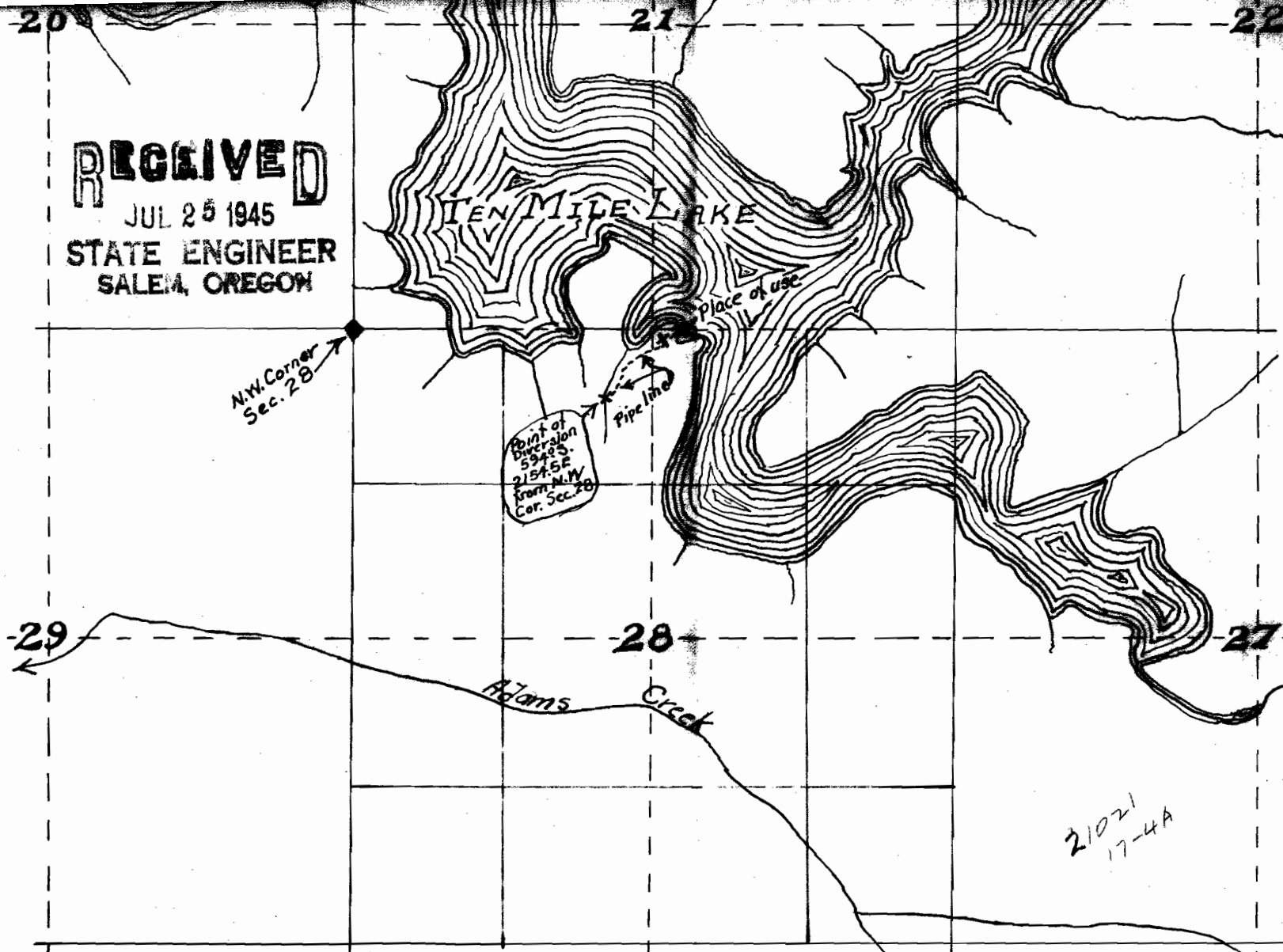

21021
17-4A

I, D.L. Buckingham, of Coos Bay, Oregon, do hereby certify that this map was made from notes taken during actual surveys made by me Jan. 8th., 1944 and July 8th., 1945, and that it correctly represents the works described in the accompanying application together with the location of all of the streams in the immediate vicinity

D.L. Buckingham



Application No. 21021
Permit No. 16443