

T.13S.R.29E.W.W.

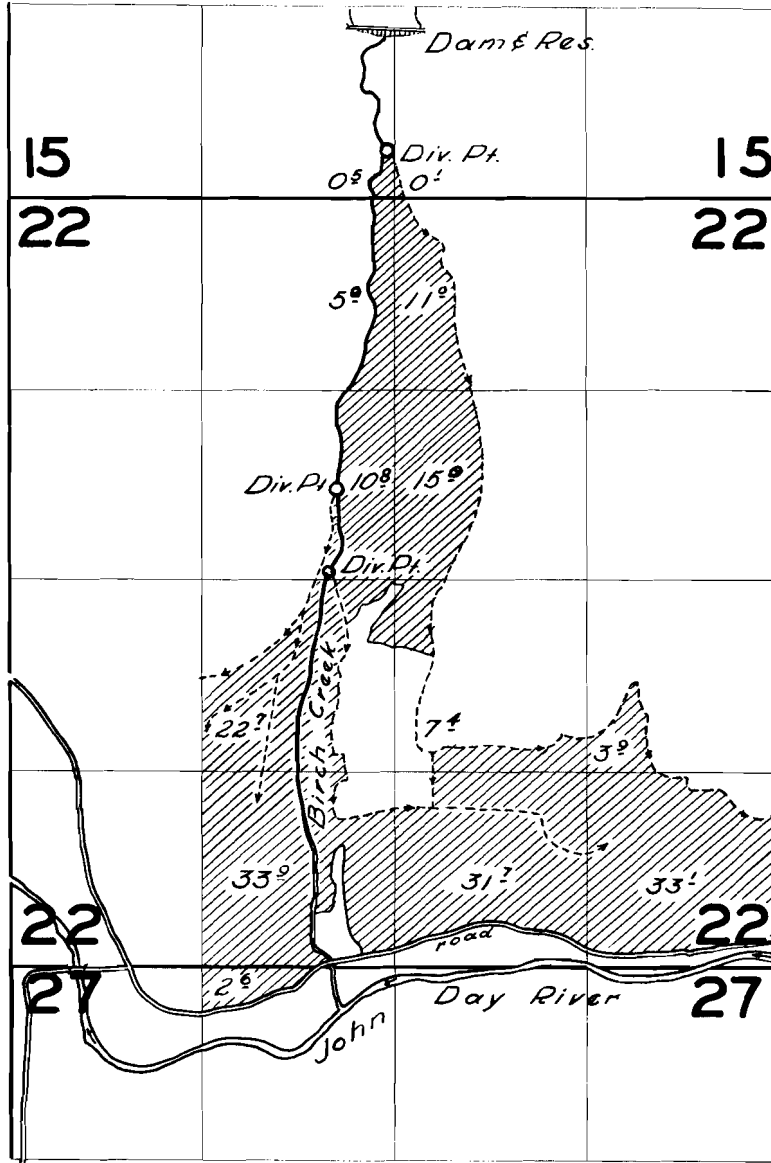

FINAL PROOF SURVEY
UNDER

Application No. 22943. Permit No. 17902.
IN NAME OF

HEIRS of ESTATE of GEORGE YOKOM, DEC'D.

Surveyed 1 Nov. 1956, by *C. A. Smith*

Map of
Yokom Dam, Reservoir
and Ditches

Scale 1 in = 660 ft. Geo. Yokom
Appropriator

T.135.

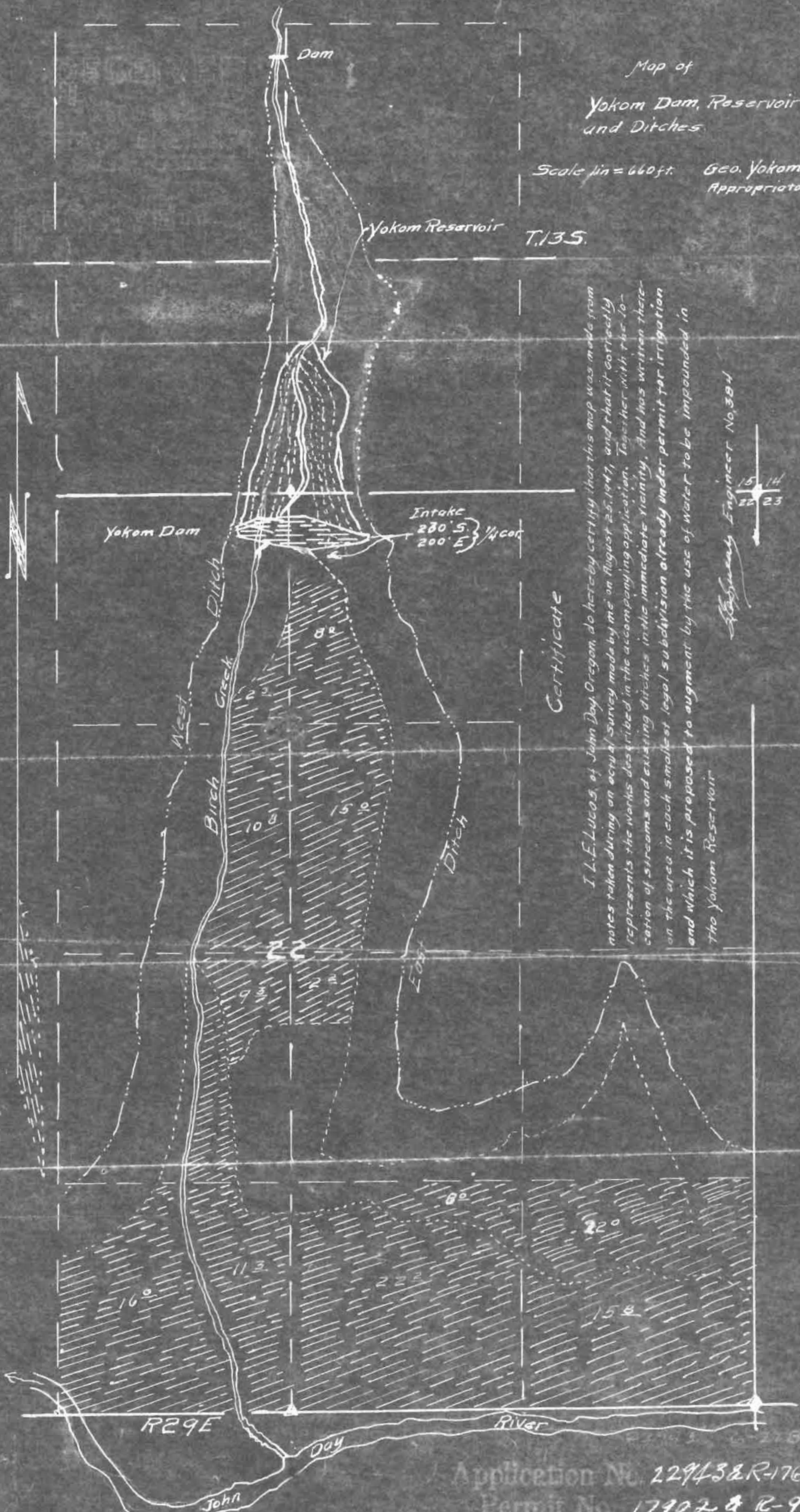

Certificate

I, L. E. Lucas, of John Day, Oregon, do hereby certify that this map was made from notes taken during an actual survey made by me on August 25, 1947, and that it correctly represents the works described in the accompanying application. Together with the location of streams and existing ditches in the immediate vicinity. And has written thereon the area in each smallest legal subdivision already under permit for irrigation and which it is proposed to augment by the use of water to be impounded in the Yokom Reservoir

Engineer No. 384

15 14
22 23

Application No. 22943 & R-1761
Permit No. 17902 & R-909