

# T.30&31S.R.6W.W.M.

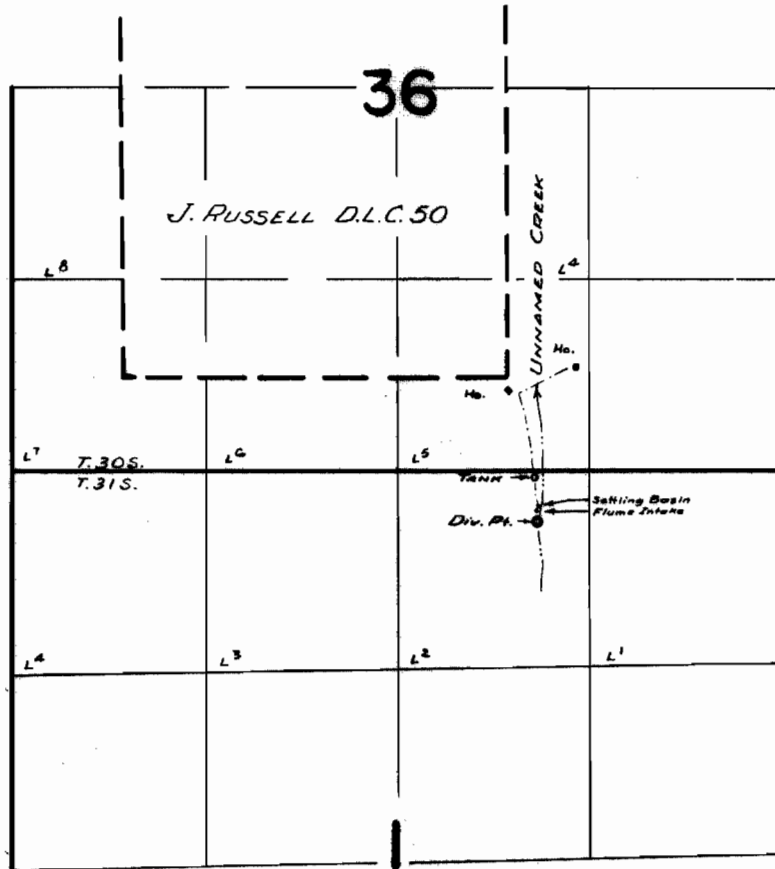

NOTE: Location of Ho<sup>3</sup> from applicants map

## FINAL PROOF SURVEY UNDER

Application No. 34379 Permit No. 27055  
IN NAME OF

WILLIAM IVAN RUSSELL

Surveyed 5 MAY 1961, by M. Bish