

T. 37 S., R. 2 W., W.M.

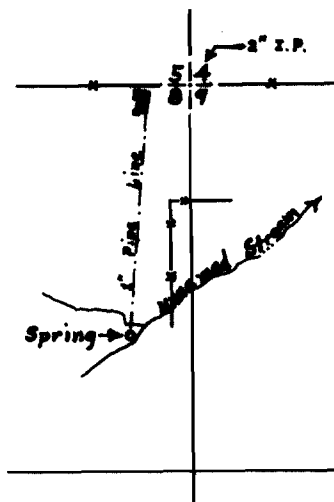

Scale: 8" = 1 mile

FINAL PROOF SURVEY
UNDER

Application No. 31849 Permit No. 25110
IN NAME OF

Cecil Ray More

Surveyed March 22, 1962, by D. G. Hendrix

RECEIVED
MAR 26 1962
STATE ENGINEER
SALEM, OREGON