

23868
51972
29969

T.9S. R.27E.W.M.

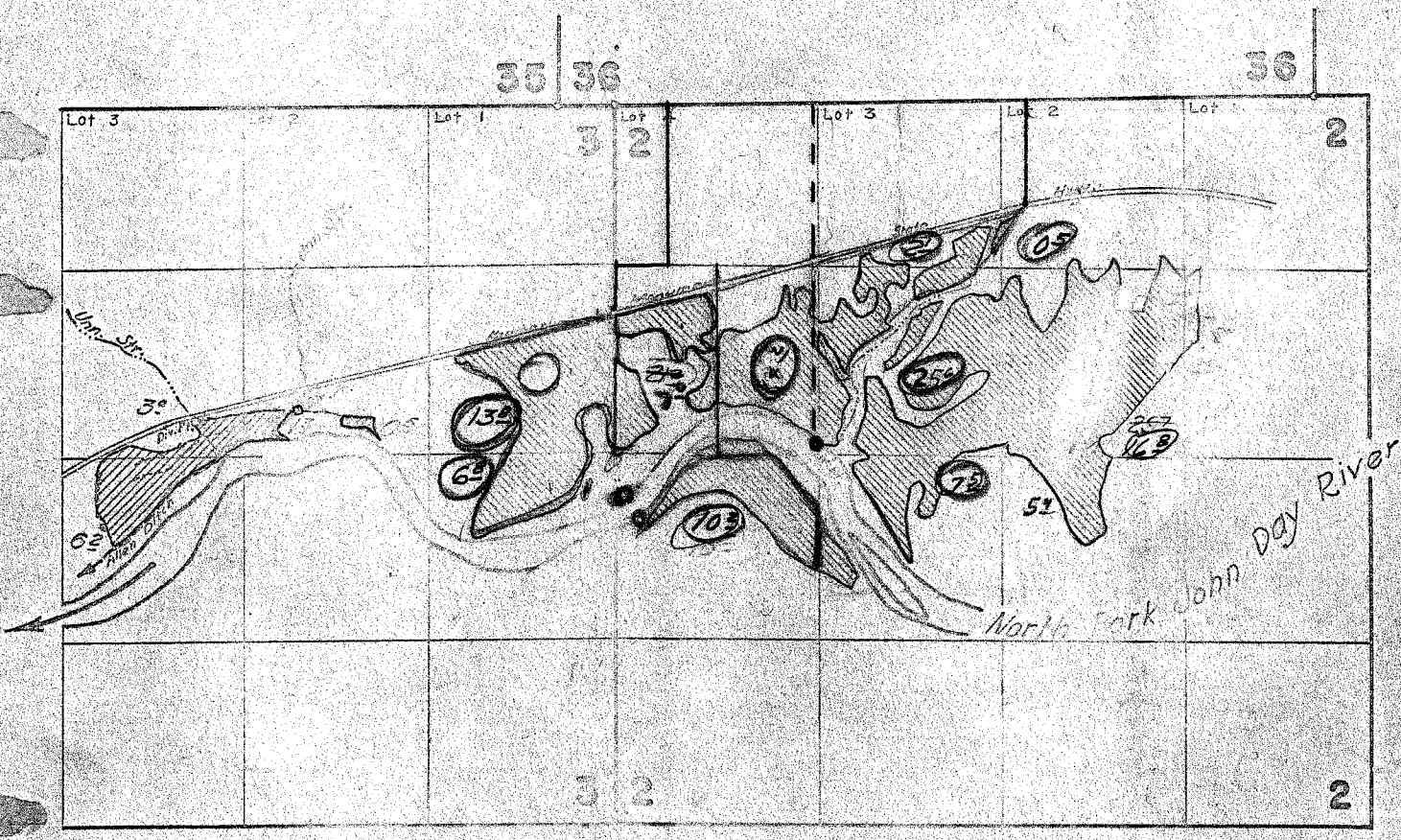

1949-1961
30342 T-C164

FINAL PROOF SURVEY UNDER

~~19892~~ ~~15459~~ *Cancelled*
~~30342~~ ~~23868~~
 Application No. 30342 Permit No. 23868
 IN NAME OF
 CLARA C. FLOWER
 LEO L. B. CLARA C. FLOWER

Surveyed *October 27, 1949*, by *H. W. Coffman*
August 30-31, 1961 by *R. Jackson*