

T. 6 S. R. 5 W. W. M.

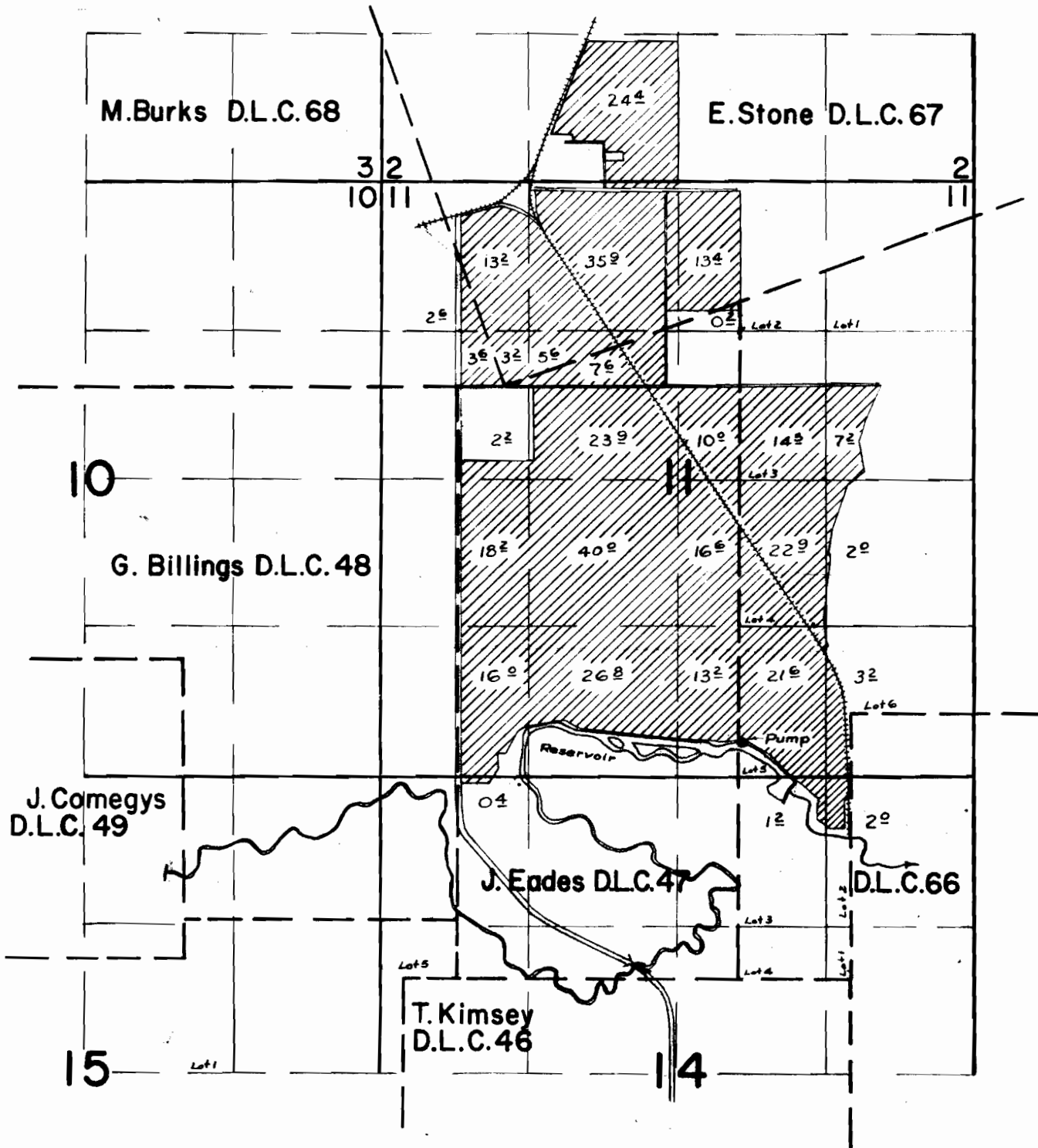

FINAL PROOF SURVEY

UNDER
 Section No. R-24551 24552 21652
 and Section No. R-1405

IN NAME OF

R. L. WALKER

July 28 61
 Surveyed Sept. 9 1960, by *m. B. Rich*

T 6 S, R 5 W, W.M.

Polk County, Oregon

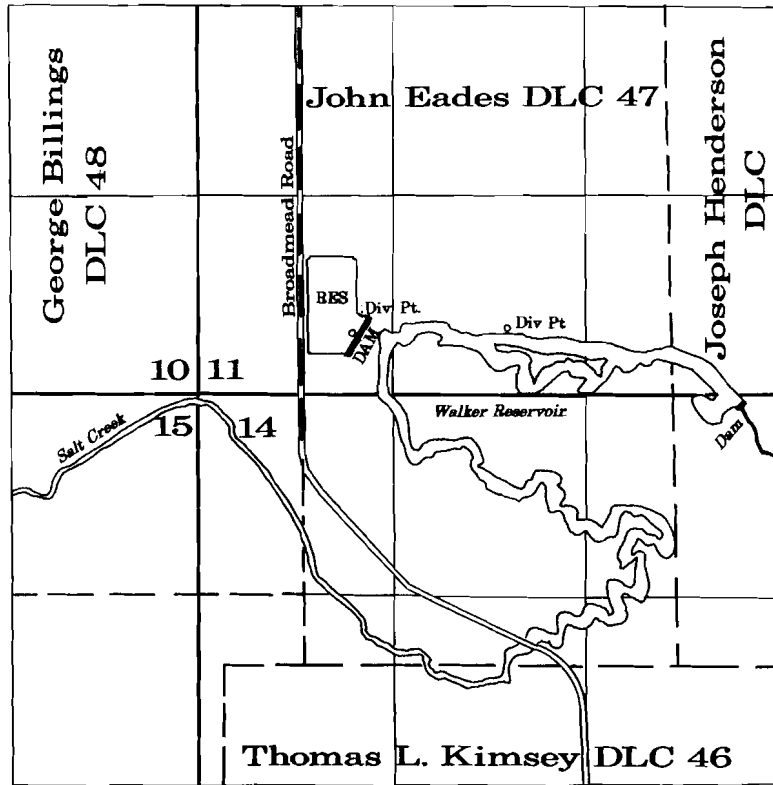

Res. Div. Pt.: 3138' South and 415' East of the NW Corner of John Eades DLC 47
 Salt Ck. Div. Pt.: 3138' South and 1420' East of the NW Corner of John Eades DLC 47

Application 24552, Permit 21652
24552 R-24551 21652 R-1405

The Broadmead Trust

rev. December 1, 1997
 rev. June 23, 1997
 August 12, 1996
 Scale: 1" = 1320'

APPLICATION TO CONSTRUCT A RESERVOIR

RECEIVED

DEC 02 1997

WATER RESOURCES DEPT.
SALEM, OREGON

NOTE: This map is for the purpose of identifying the location of water rights and has no intent to dimension or locate property ownership lines.

