

SE 1/4 of SW 1/4 of Sec 25

Fork of Harris Creek  
 SW 1/4 of SE 1/4 of Sec 25

3 1/4 in IP.  
 Point of diversion  
 630.13 North + 37.43 East  
 of 1/4 Cor between Secs 25 + 36  
 Headgate

Sec 25  
 Sec 36

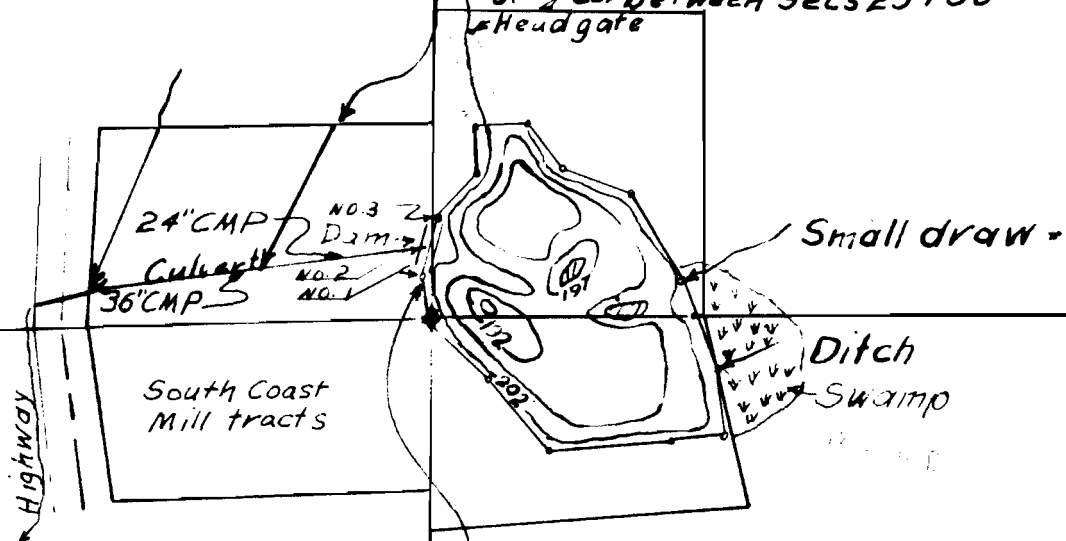

NE 1/4 of NW 1/4 of Sec 30

NW 1/4 of NE 1/4 of Sec 36

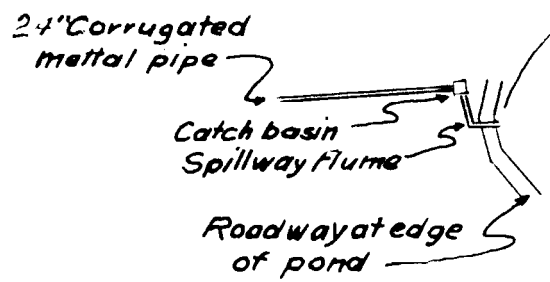

APPROX

STATE ENGINEER

Application No. R-32622 + 32623  
 Permit No. R-2176 + 25733

South Coast Mill Pond

Sections 25 + 36 T40S R14W  
 Scale 1" = 330'  
 Original dam  $\odot$   
 Contour Interval 50'  
 Elevation of Waterline 202'  
 1/4 Corner Sections 25 + 36  $\blacklozenge$



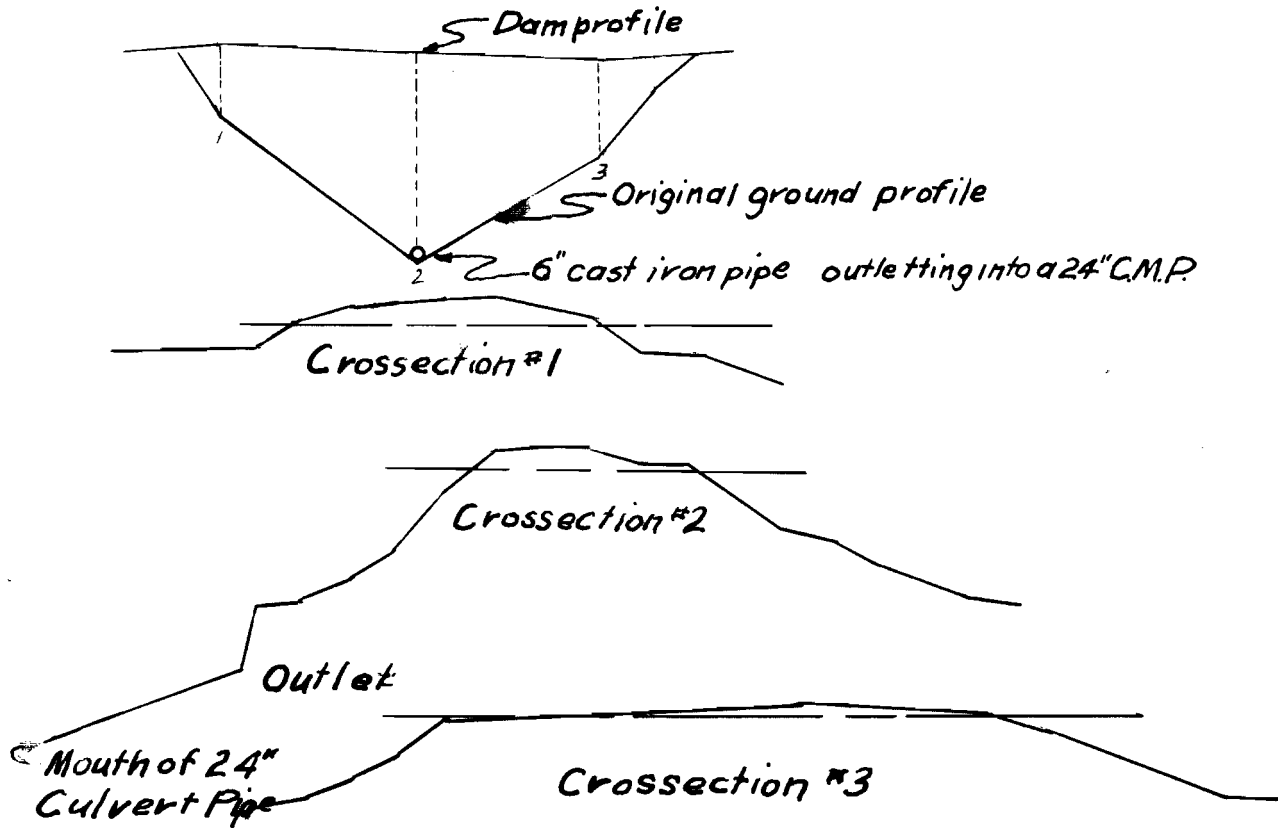

Crosssections of South Coast  
 Mill Pond Dam  
 Scale Vertical 1" = 20'  
 Horizontal 1" = 20'  
 Waterline

Dec. 16 58

*Lewis A. Stanley*  
 STATE ENGINEER

I B.A. Martin of Brookings, Oregon  
 Do hereby certify that this map was made from  
 notes taken during an actual survey under my  
 immediate supervision on March 12 1956; that  
 the monument shown on this map consisting of a  
 1" iron pipe driven 30" into the ground is 630.13 North  
 and 37.43' East of  $\frac{1}{4}$  corner between sections 25  
 and 36 township 40 South Range 14 West, W.M.

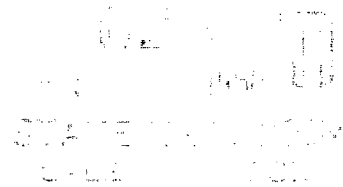

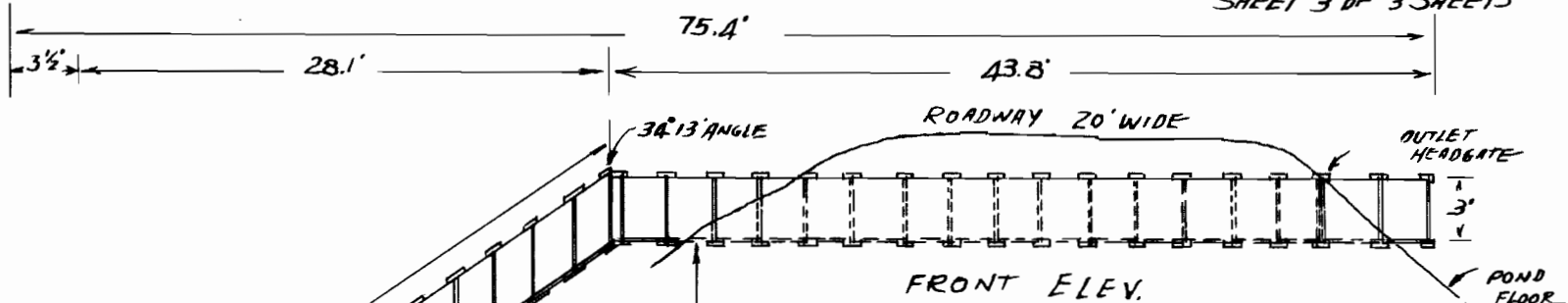

FRONT ELEV.  
OUTLET, FLUME & SPILLWAY

APP. Dec. 16 58  
*Lewis A. Stanley*  
 STATE ENGINEER

6" MASTER DRAIN PIPE W/GATE VALVE. PIPE THRU EMBANKMENT AT BOTTOM LEVEL OF LOB POND. 3' X 5' GRIZZLY  
 2' X 2' GRIZZLY MASTER DRAIN  
 24" MASTER DRAIN PIPE UNDERGROUND  
 MASTER DRAIN FLUME 4 1/2' WIDE X 4' DEEP

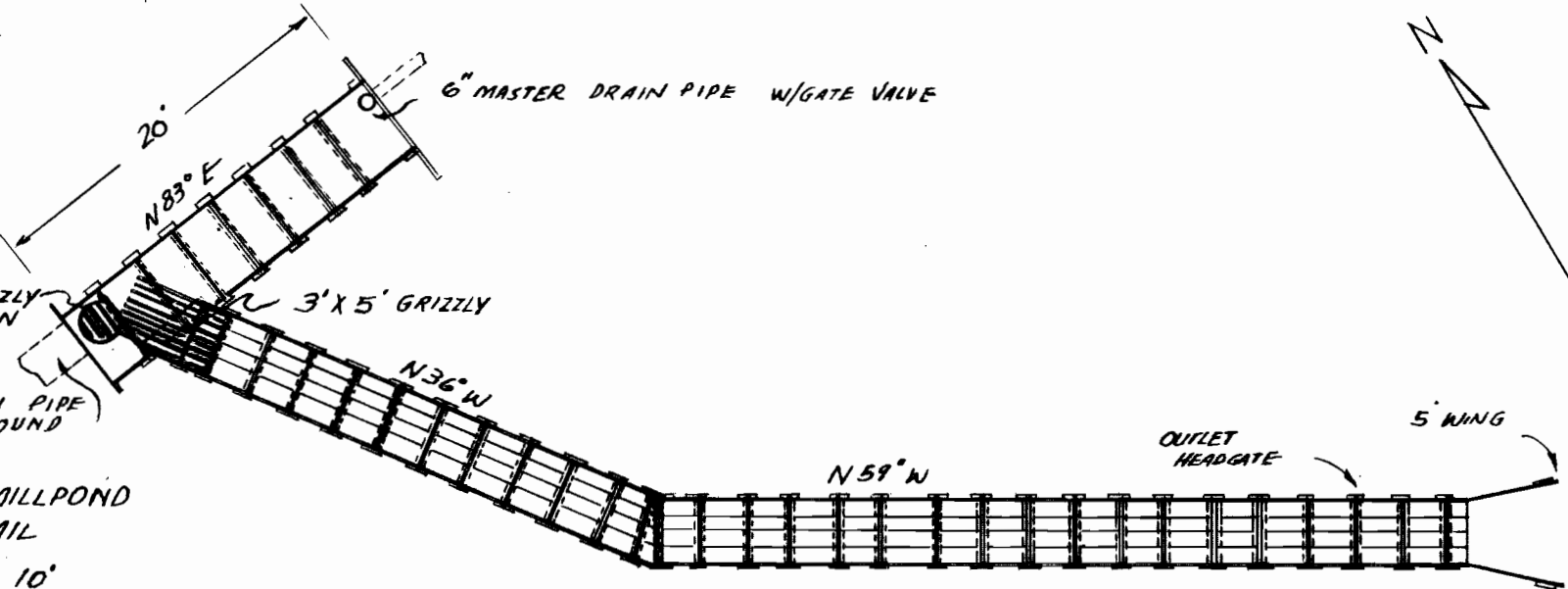
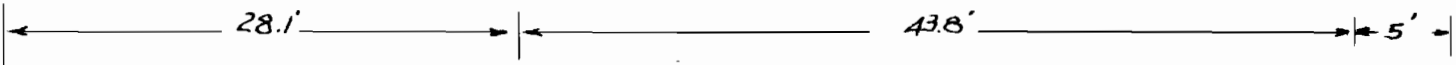

FLOOR PLAN

SOUTH COAST MILLPOND  
 OUTLET DETAIL  
 SCALE: 1" = 10'

