

SE 1/4 of SW 1/4 of Sec 25

Fork of Harris Creek
 SW 1/4 of SE 1/4 of Sec 25

3 1/4 in IP.
 Point of diversion
 630.13 North + 37.43 East
 of 1/4 Cor between Secs 25 + 36
 Headgate

Sec 25
 Sec 36

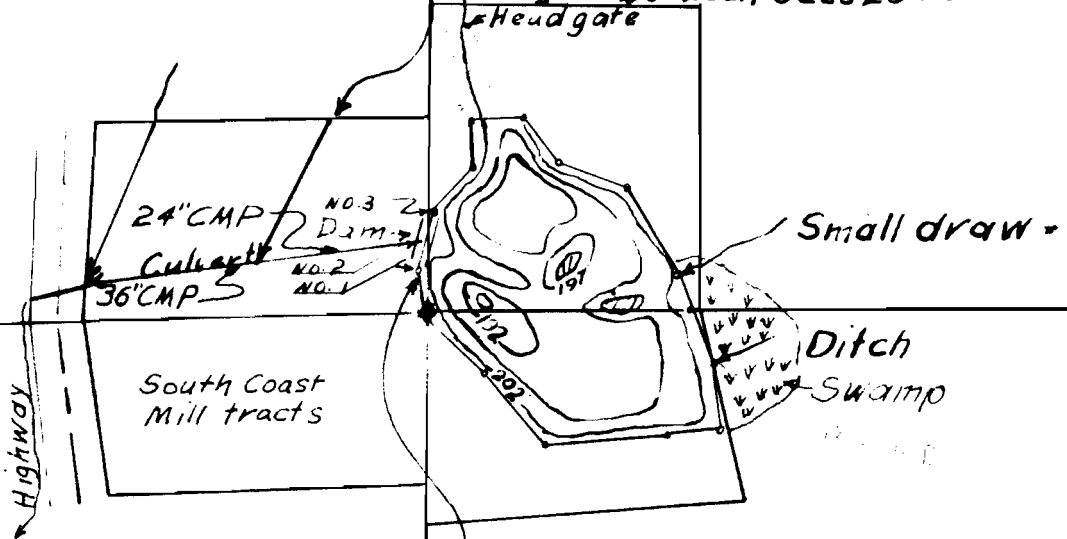

NE 1/4 of NW 1/4 of Sec 30

NW 1/4 of NE 1/4 of Sec 36

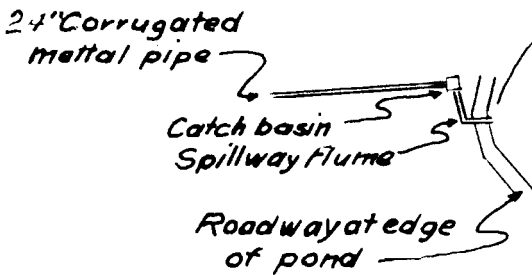

APPROX

STATE ENGINEER

Application No. R-32622 + 32623

Permit No. R-2176 + 25733

South Coast Mill Pond

Sections 25 + 36 T40S R14W

- | | | |
|-----------------------------|-----------|-----------------|
| Scale | 1" = 330' | Application No. |
| Original dam | ⊙ | |
| Contour Interval | 50' | |
| Elevation of Waterline | 202' | |
| 1/4 Corner Sections 25 + 36 | ◆ | |



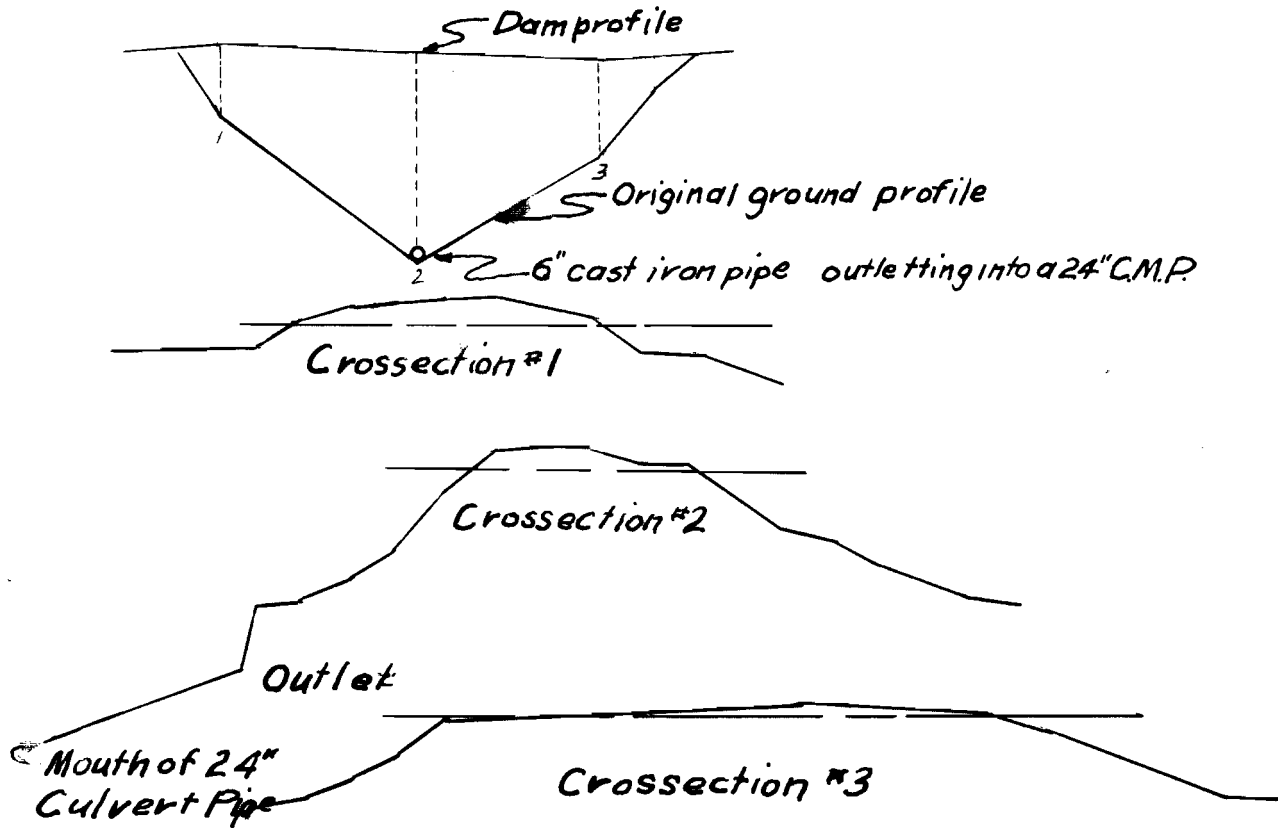

Crosssections of South Coast
 Mill Pond Dam
 Scale Vertical $1" = 20'$
 Horizontal $1" = 20'$
 Waterline

Dec. 16 58

Lewis A. Stanley
 STATE ENGINEER

I B.A. Martin of Brookings, Oregon
 Do hereby certify that this map was made from
 notes taken during an actual survey under my
 immediate supervision on March 12 1956; that
 the monument shown on this map consisting of a
 1" iron pipe driven 30" into the ground is 630.13 North
 and 37.43' East of $\frac{1}{4}$ corner between sections 25
 and 36 township 40 South Range 14 West, W.M.

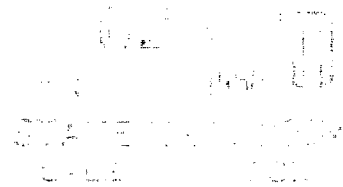

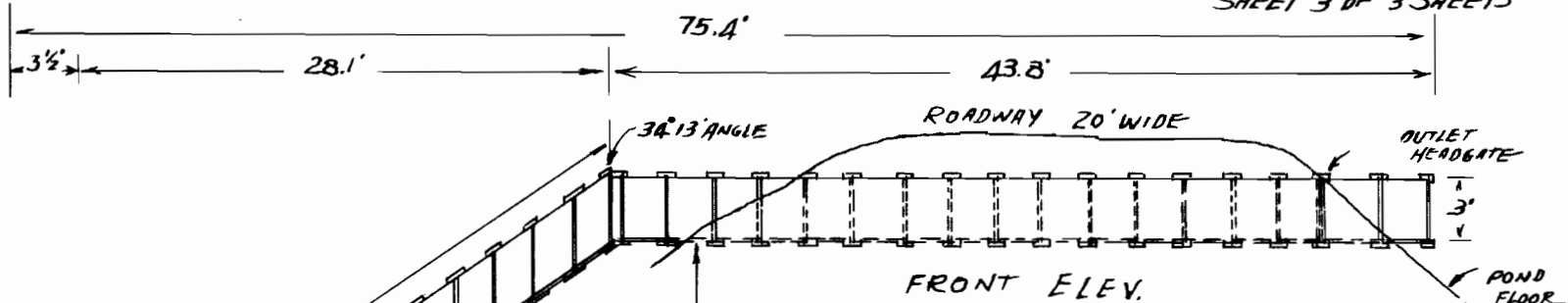

FRONT ELEV.
OUTLET, FLUME & SPILLWAY

APP. Dec. 16 58
Lewis A. Stanley
 STATE ENGINEER

6" MASTER DRAIN PIPE W/GATE VALVE. PIPE THRU EMBANKMENT AT BOTTOM LEVEL OF LOB POND. 3' X 5' GRIZZLY
 2' X 2' GRIZZLY MASTER DRAIN
 24" MASTER DRAIN PIPE UNDERGROUND
 MASTER DRAIN FLUME 4 1/2' WIDE X 4' DEEP

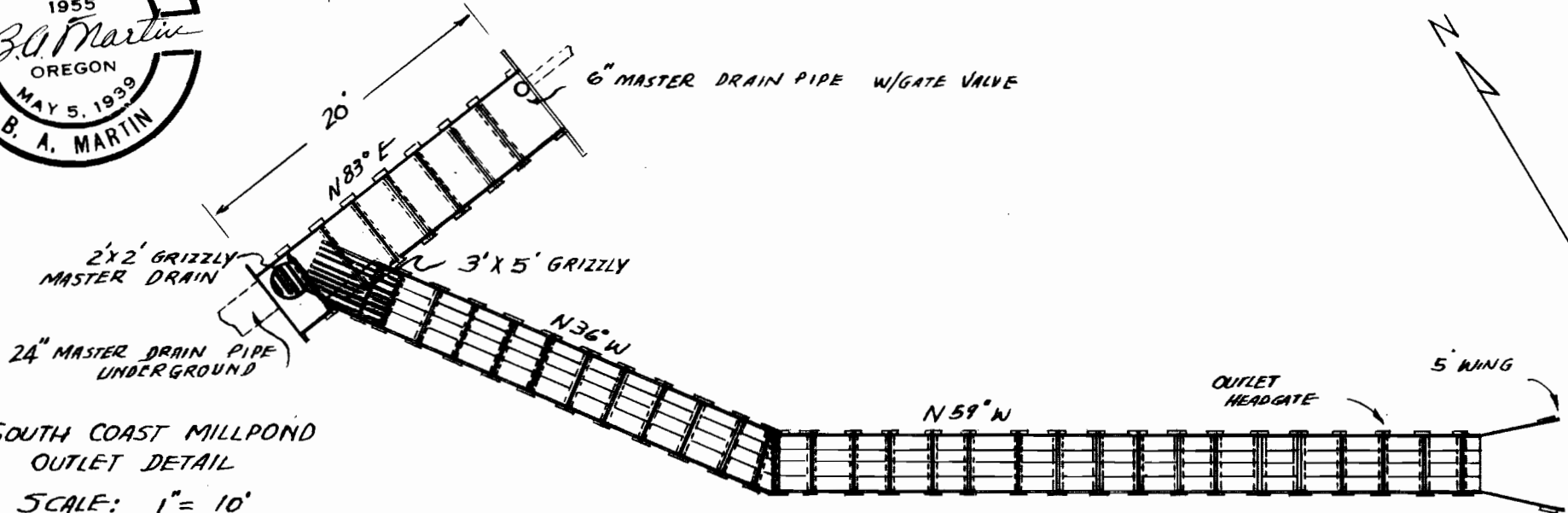
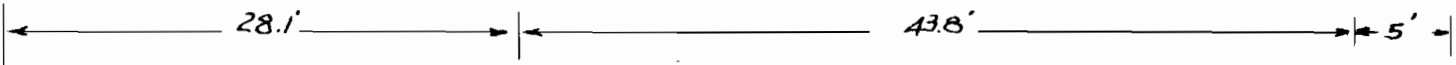

FLOOR PLAN

SOUTH COAST MILLPOND
 OUTLET DETAIL
 SCALE: 1" = 10'

