

SURVEYORS CERTIFICATE

I, W.E. Anderson of Tillamook, Ore do hereby certify that this map was made from notes taken by me in Nov. 1957 and that correctly represents the works herein.

W.E. Anderson

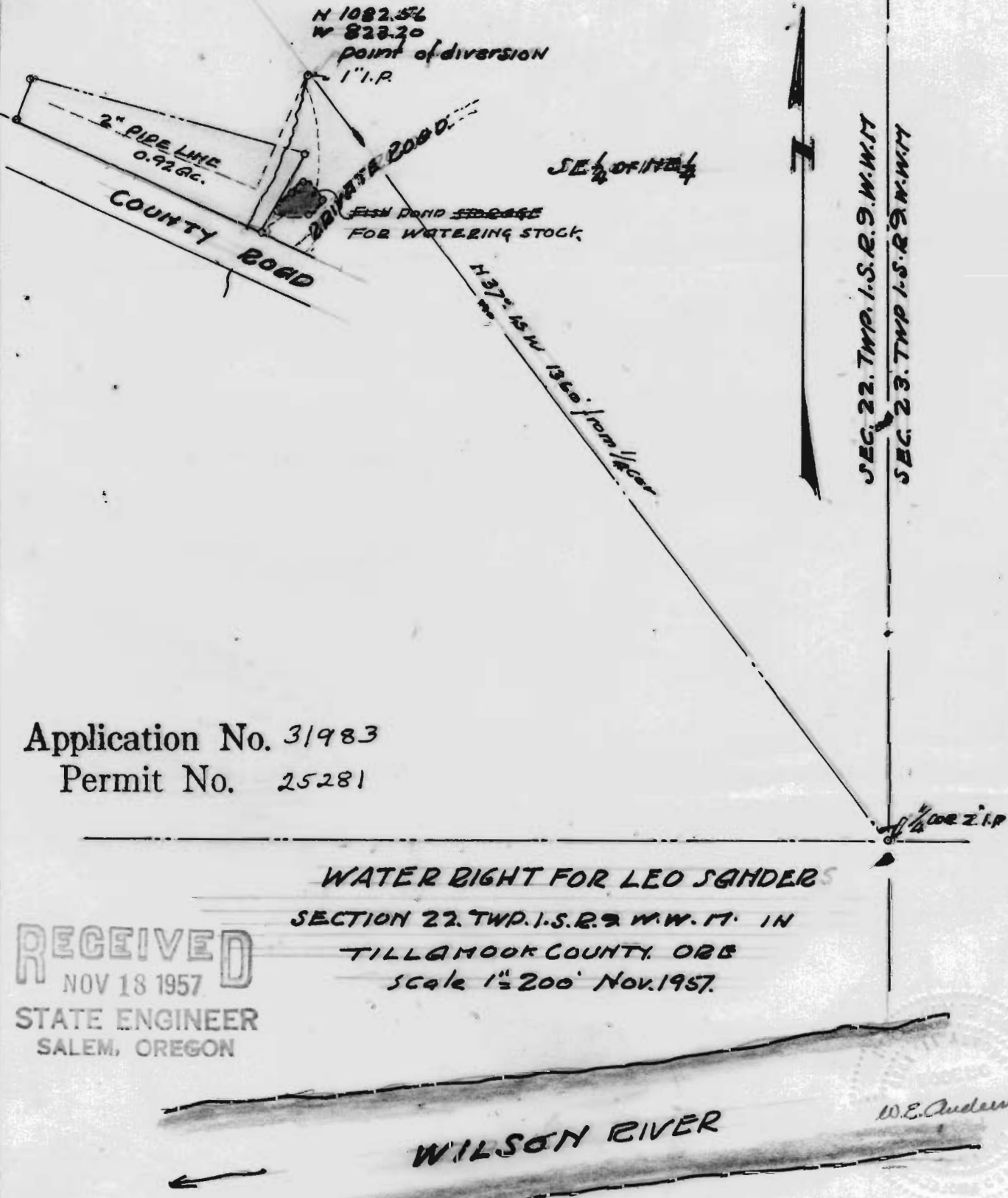

Application No. 31983

Permit No. 25281

WATER RIGHT FOR LEO SANDERS

SECTION 22. TWP. 1.S.R. 9.W.W. 17. IN

TILLAMOOK COUNTY, ORE

Scale 1" = 200' Nov. 1957.

RECEIVED
NOV 18 1957

STATE ENGINEER
SALEM, OREGON

WILSON RIVER

W.E. Anderson