

T. 9 S. R. 3 W. W. M.

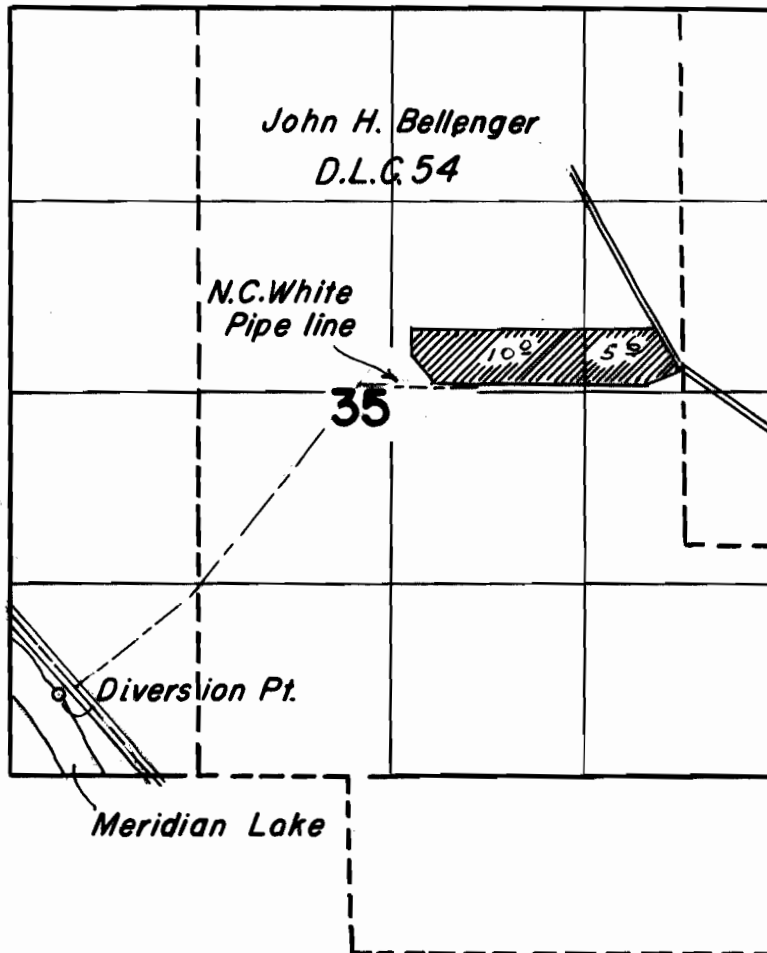

Note.  
Diversion point from  
Meridian lake located  
from final proof  
survey for N.C. White  
Certificate 27571

**FINAL PROOF SURVEY**  
UNDER

Application No. 33187 Permit No. 26247  
IN NAME OF

Robert A. Terhune

Surveyed Aug. 27 1962, by Floyd L. Sigmond