

THE WILLOW VALLEY IRRIGATION DISTRICT.

Map accompany application for permit to appropriate water.
Scale 1"=2000'

May 1920.

Application No. R-7397
Reservoir No. R-625

Application No. 7398
Reservoir No. 9416

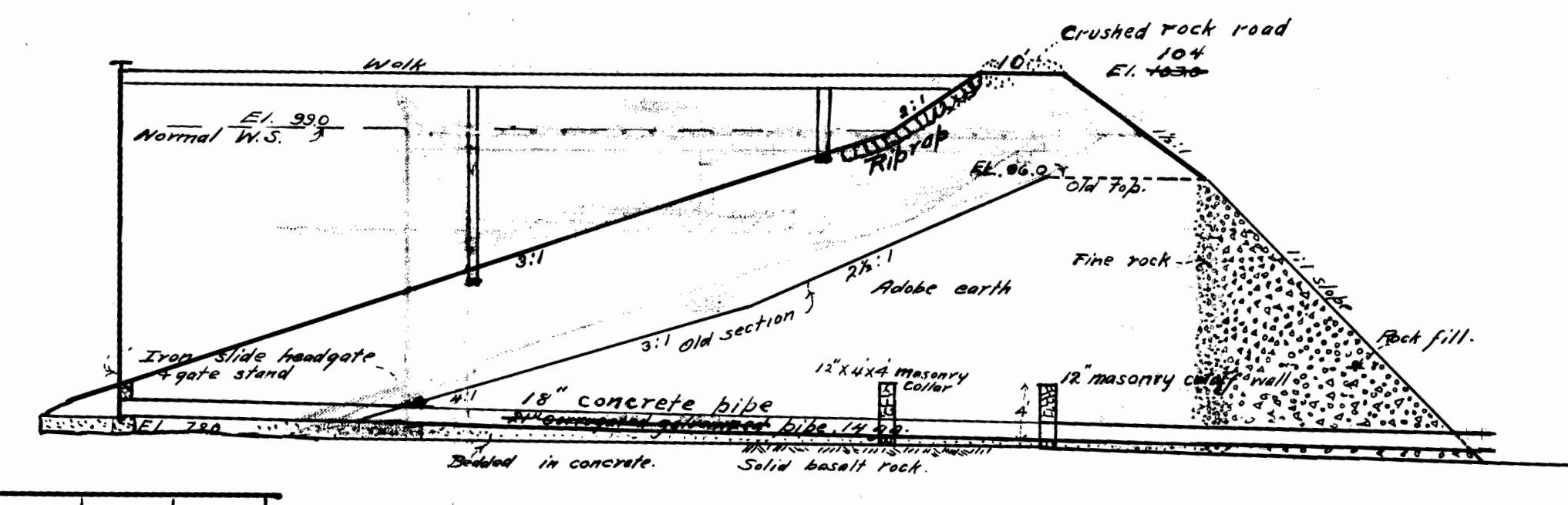
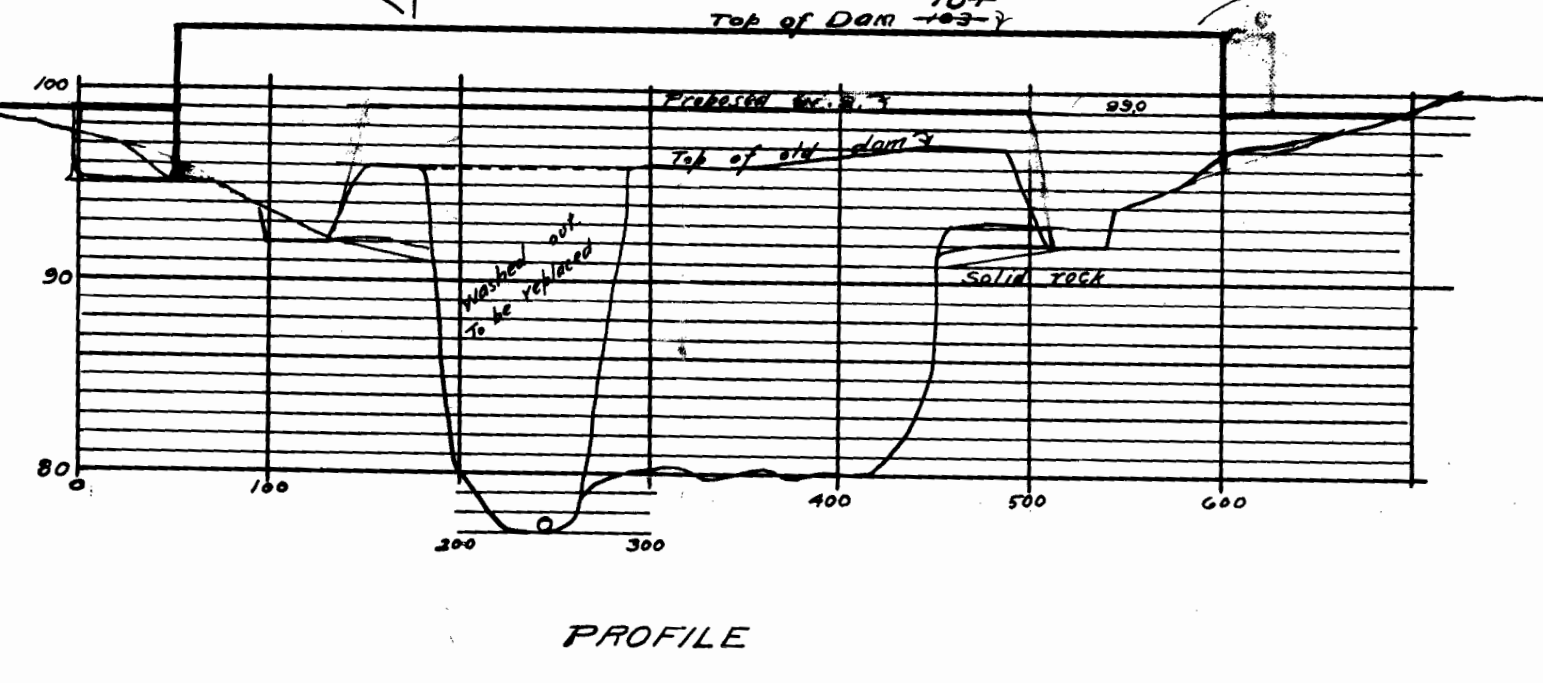
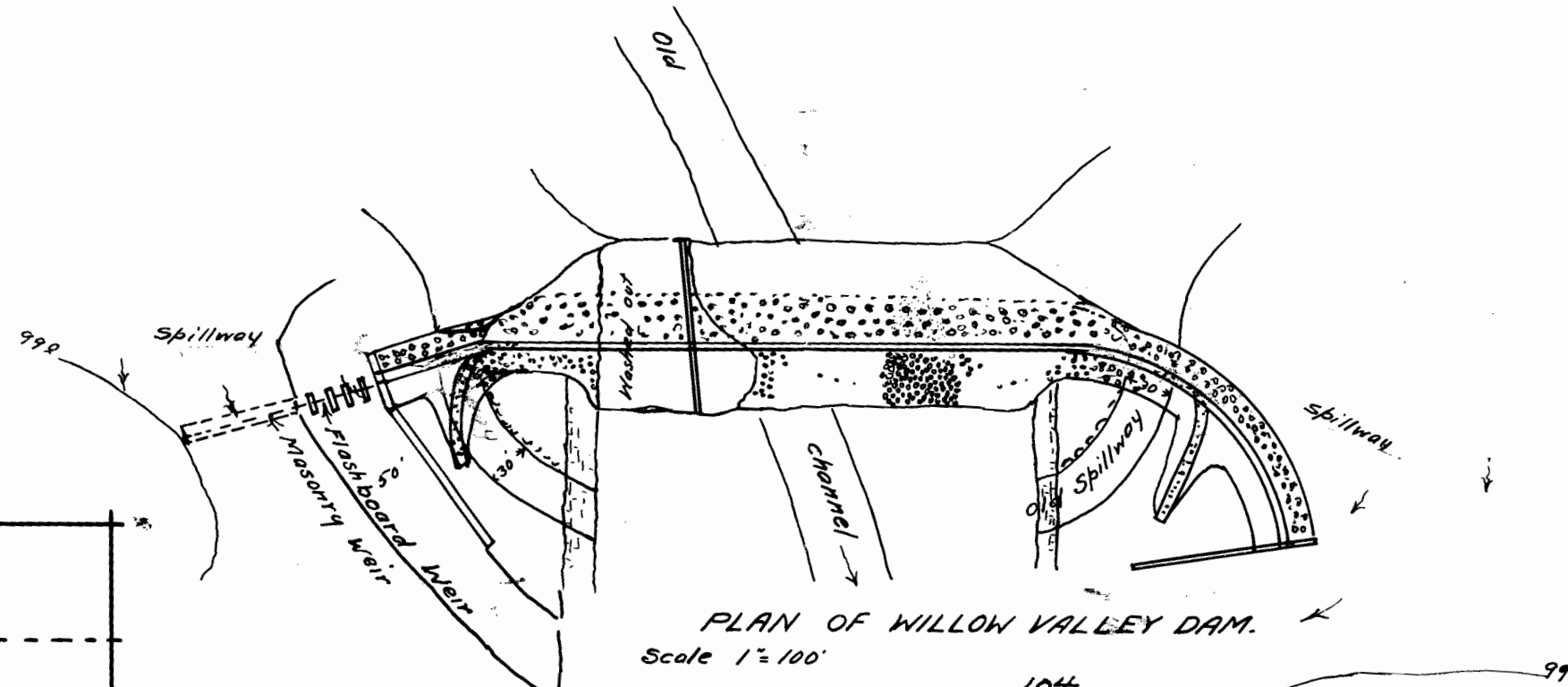
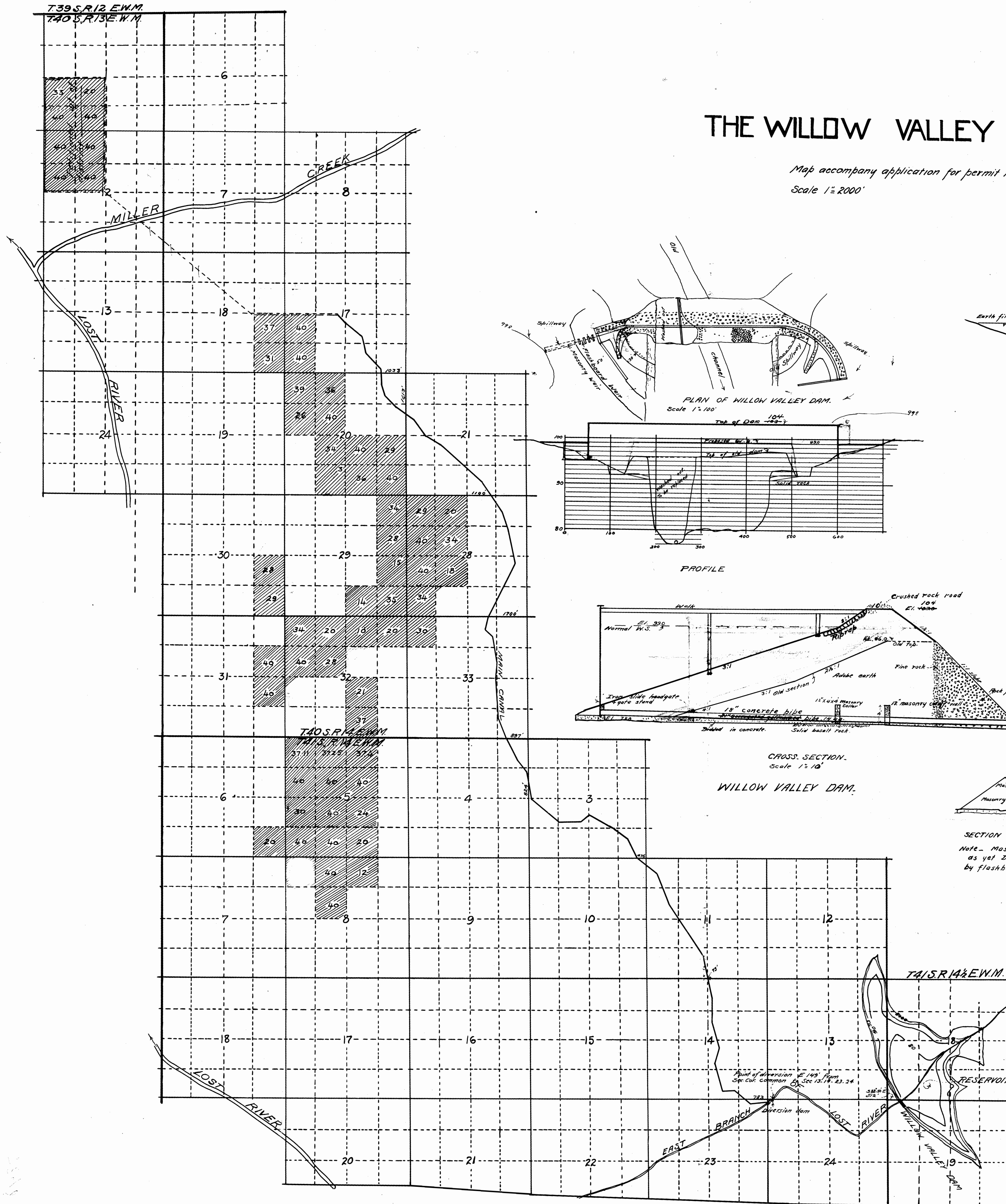

CROSS SECTION.
Scale 1"=10'
WILLOW VALLEY DAM.

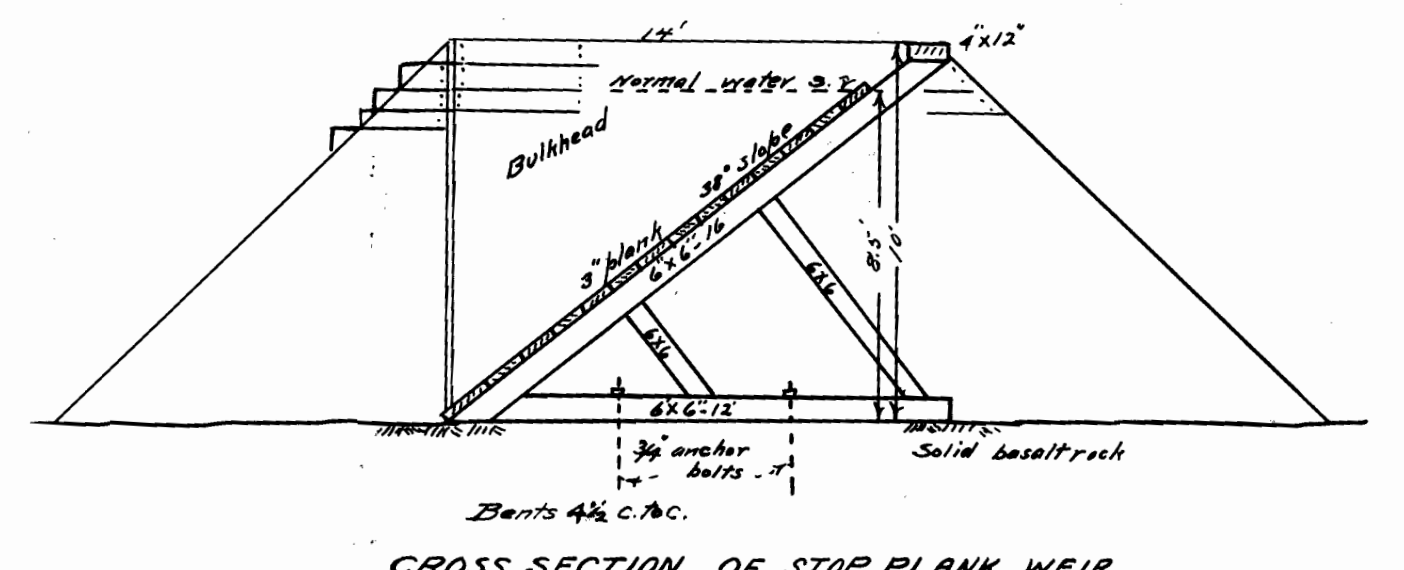
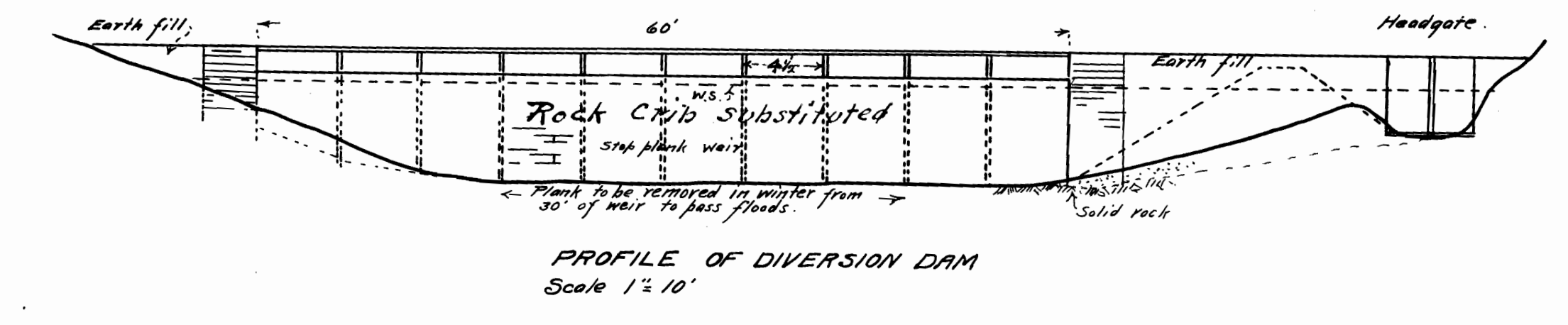

DIVERSION DAM.



SECTION OF SPILLWAY
Note - Masonry weir not constructed as yet Dec. 1919. To be broken by flashboard weir.

Application No. 7397
Reservoir Permit No.
Application No. 7398

CERTIFICATE OF SURVEYOR

I, John C. Cleghorn, do hereby certify that this map was made from a map made from actual surveys made for R.F. Tuttle and Wm. Duncan under the supervision of E.B. Henry on Aug. 15, 1910 to Oct. 15, 1910 and so certified and sworn to by him on said map, and from a map made by C.T. Darley from notes taken during a survey said to have been made by him on April 22+30, 1918, and the plans for the dams were made from notes taken during an actual survey of the sites made by me on May 18, 1920, that I believe that this map correctly represents the streams and ditches in the immediate vicinity.

Klamath Falls, Ore.
May 27, 1920.

John C. Cleghorn
John C. Cleghorn

Capacity	4527 acre feet
Area of contour 20'	208 acres
" " " 25'	169 "