

T.31S. R.3W. W.M.

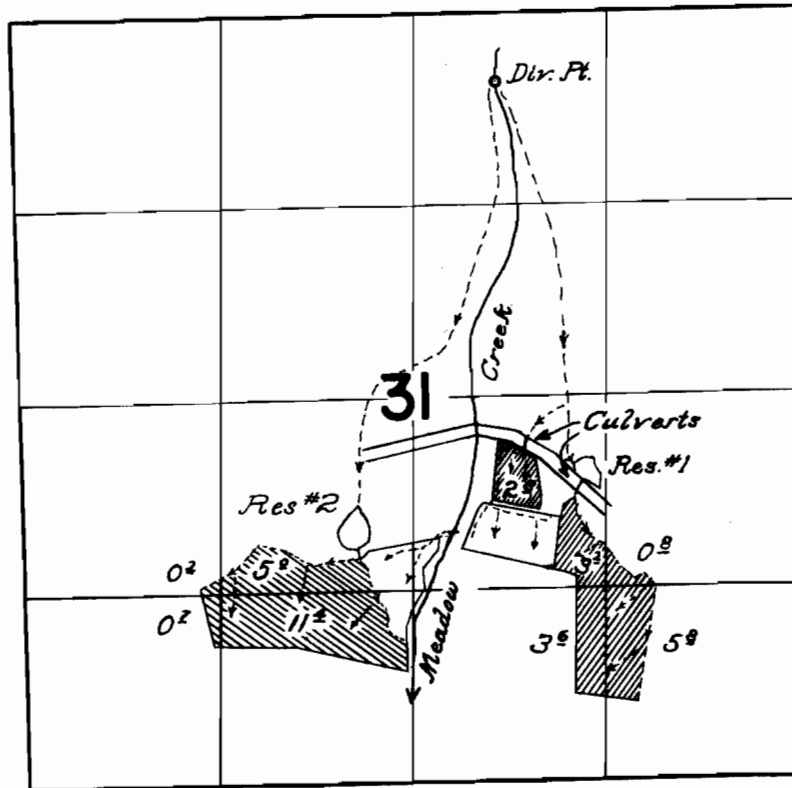

 Supplemental
  Primary

FINAL PROOF SURVEY UNDER

R-32702 R-2197
 32703 25834
 R-32704 R-2198
 Application No. 32705... Permit No. 25835
 IN NAME OF

Harry L. & Eugina J. Natenstedt

Surveyed August 10, 1962, by Thomas R. Lauer