

T.35S.R.14E.W.M.

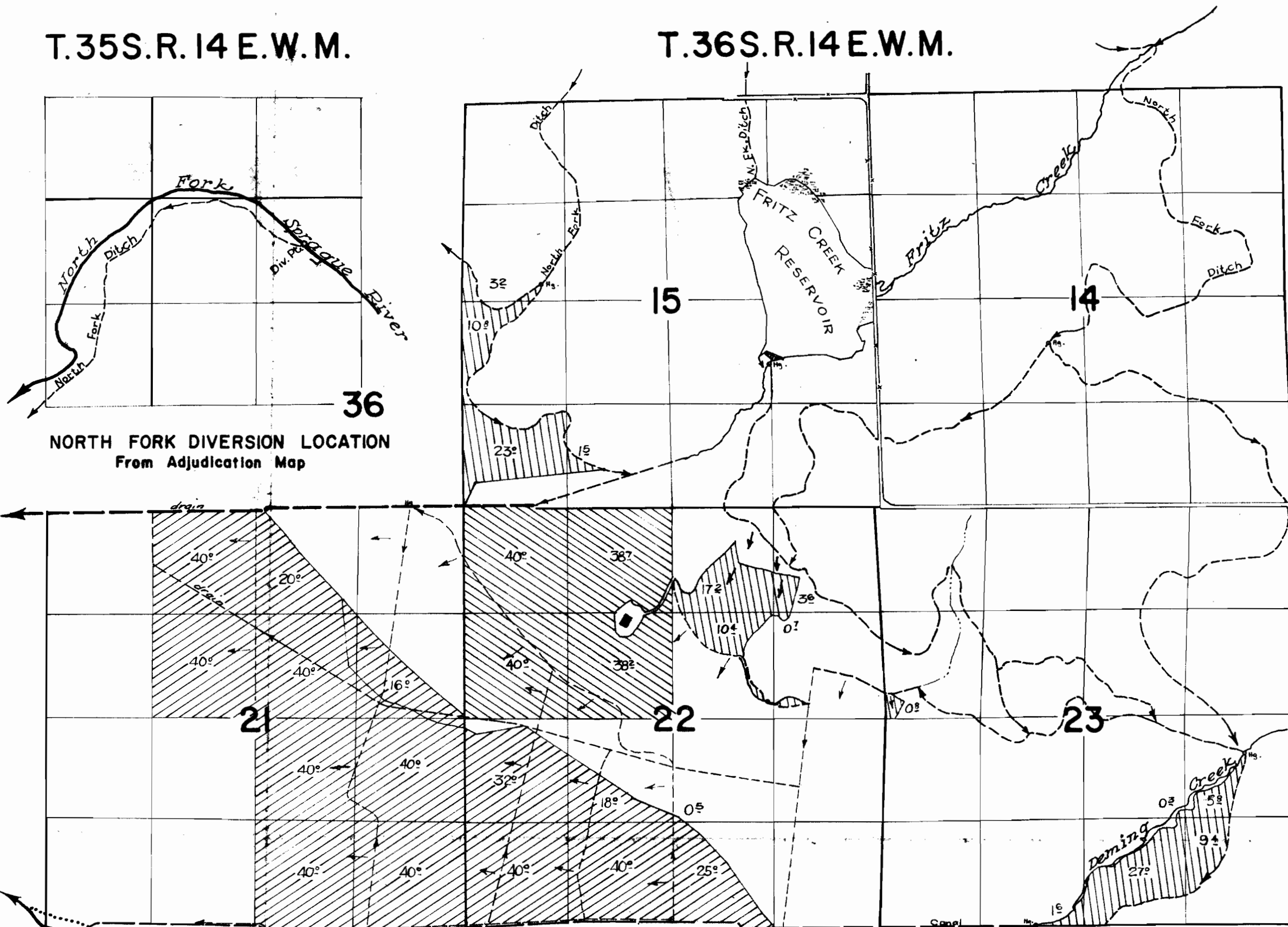

T.36S.R.14E.W.M.



NORTH FORK DIVERSION LOCATION  
From Adjudication Map

# FINAL PROOF SURVEY

UNDER

Application 25527	Permit 23741	
R-28647	R-1553	
28648	22565	
30526	24036	

IN NAME OF

FREDERICK W. & ELIZABETH H. HYDE

Surveyed August 15-16, 1962 by *H. Nelson*