

T.5S.R.2W.W.M.

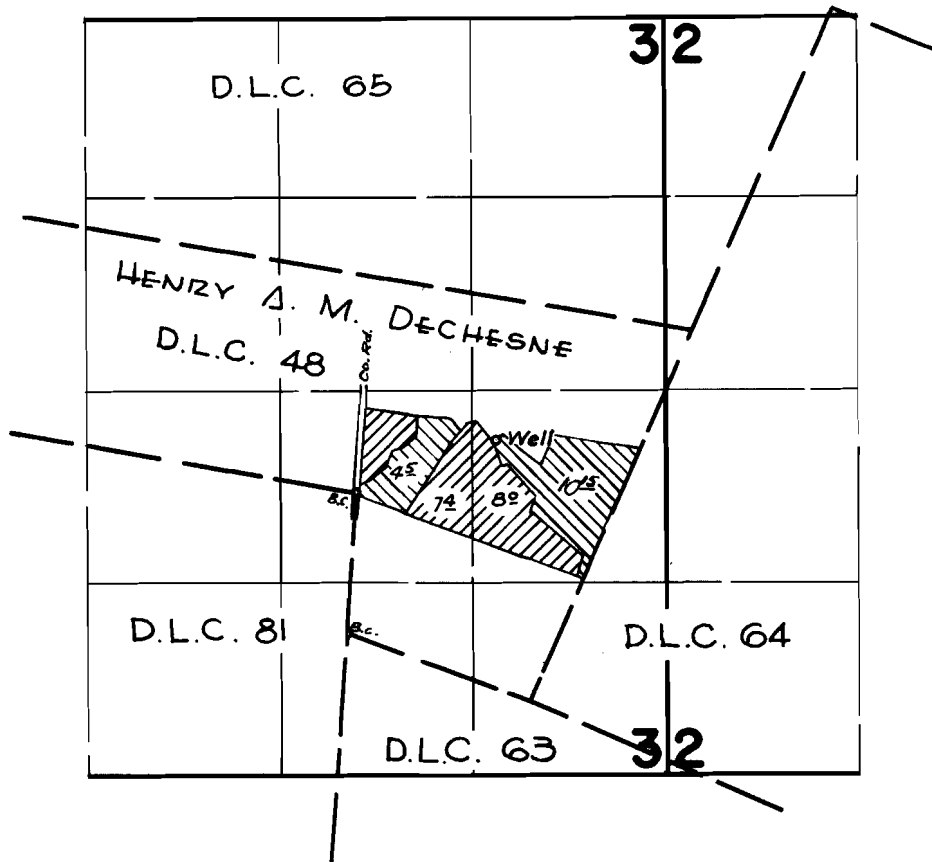

WELL LOC: 1320' N. & 1000' E. FROM S.W. COR. D.L.C. 48

FINAL PROOF SURVEY UNDER

Application No. G-5400 G-5325
G-2257 Permit No. G-2074
IN NAME OF



HENRY & MARY F. DINGES

Surveyed April 23 1963, by T. LAUER
AUG. 3, 1976 R. MUCKEN