

SECTION 21, TOWNSHIP 35 SOUTH, RANGE 5 WEST OF W. M.  
JOSEPHINE COUNTY OREGON.

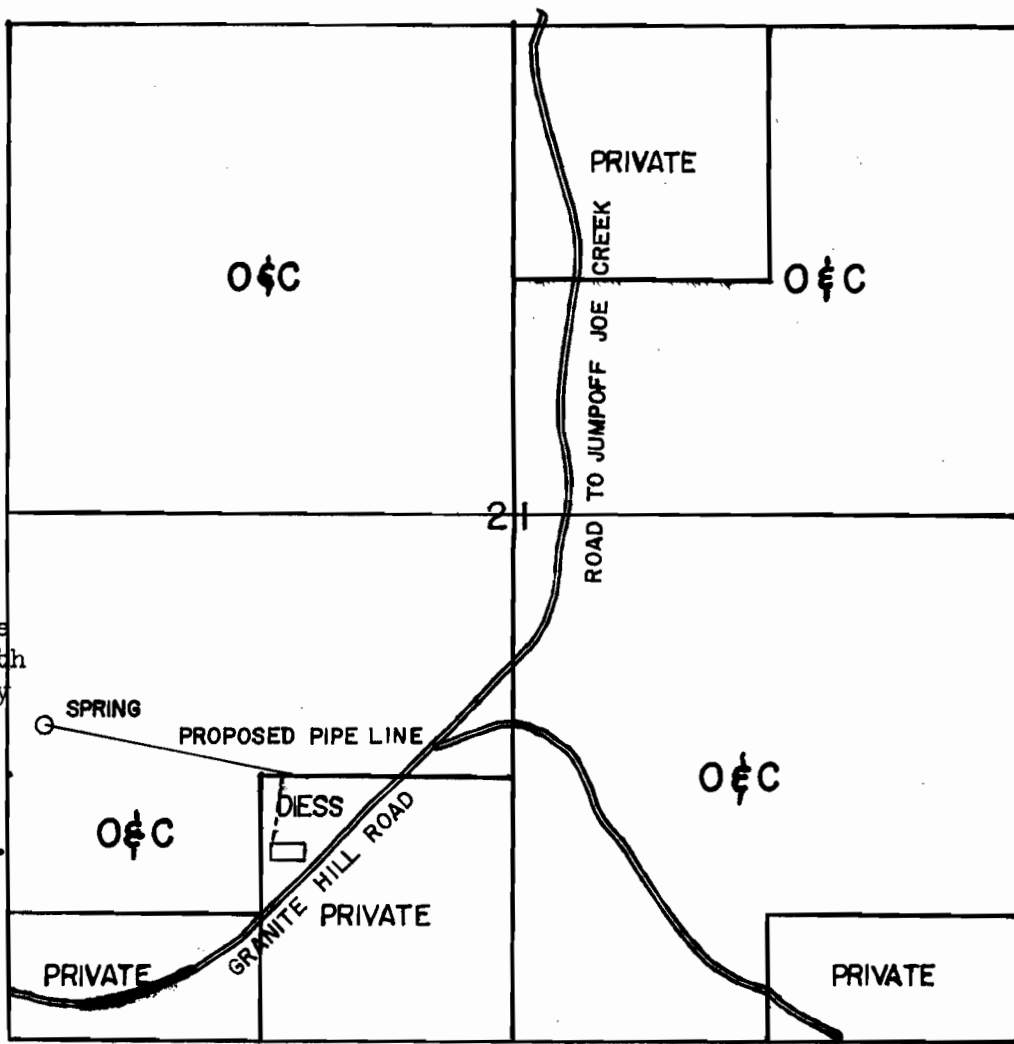

Proposed pipeline  
1300 ft. in length  
to Diess property  
line.

From 1/16TH COR.  
north 248 ft.  
then east 168 ft.

SCALE

0 1000 2000 3000

Application No. 34889

Permit No. 27380