

T. 7 S. R. 1 W. W. M.

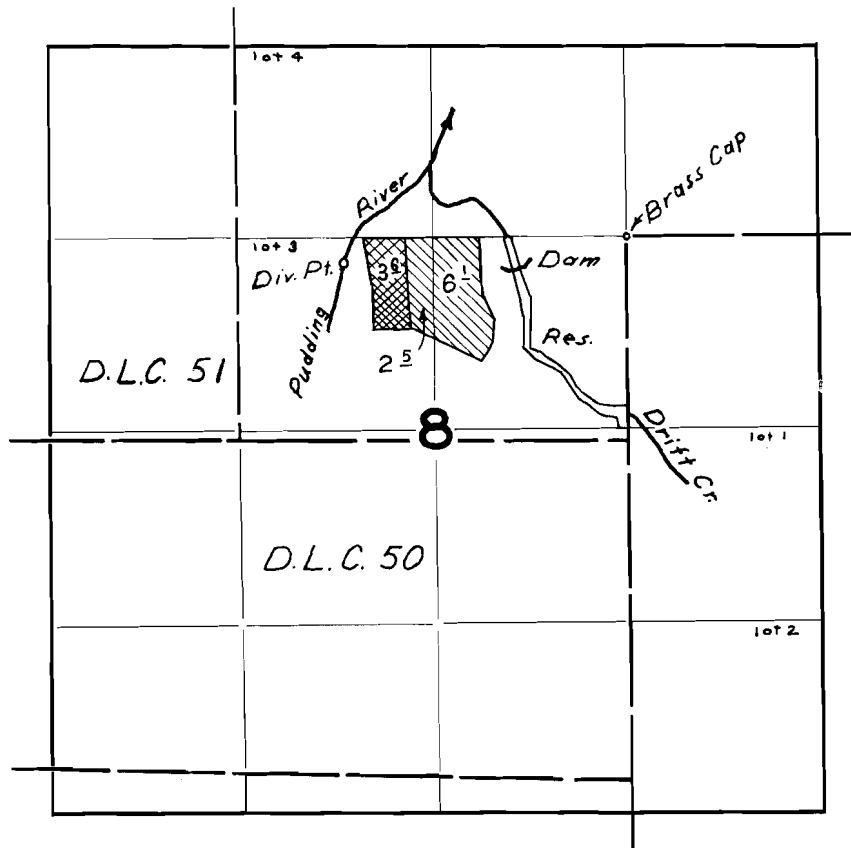

32660 - Primary from Pudding River



37259 - Supplemental from Drift Cr. Res.

FINAL PROOF SURVEY UNDER

Application No. 32660 Permit No. 25755
37259 27758
R-37258 R-2708

IN NAME OF





CARL A. SCHMID

Surveyed MAY 21 1964, by F. L. SIEGMUND

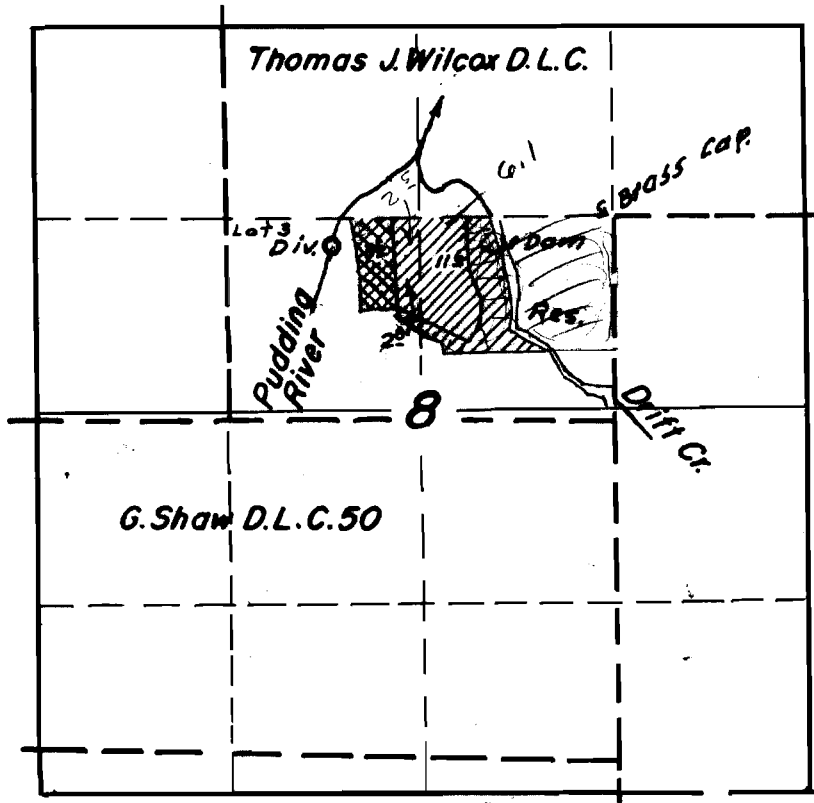
T.7S. R.1W.W.M.

Superseded



	Sum Area Res.		37259
	32660 Perm for		32660 ✓

FINAL PROOF SURVEY
UNDER

	37259	27758
	R 37258	R 2708
Application No.	32660	Permit No. 25755

IN NAME OF

Carl Schmid

Surveyed *May 21* 1964, by *Floyd L. Sigmund*