

# T. 7 S. R. 6 W. W. M.

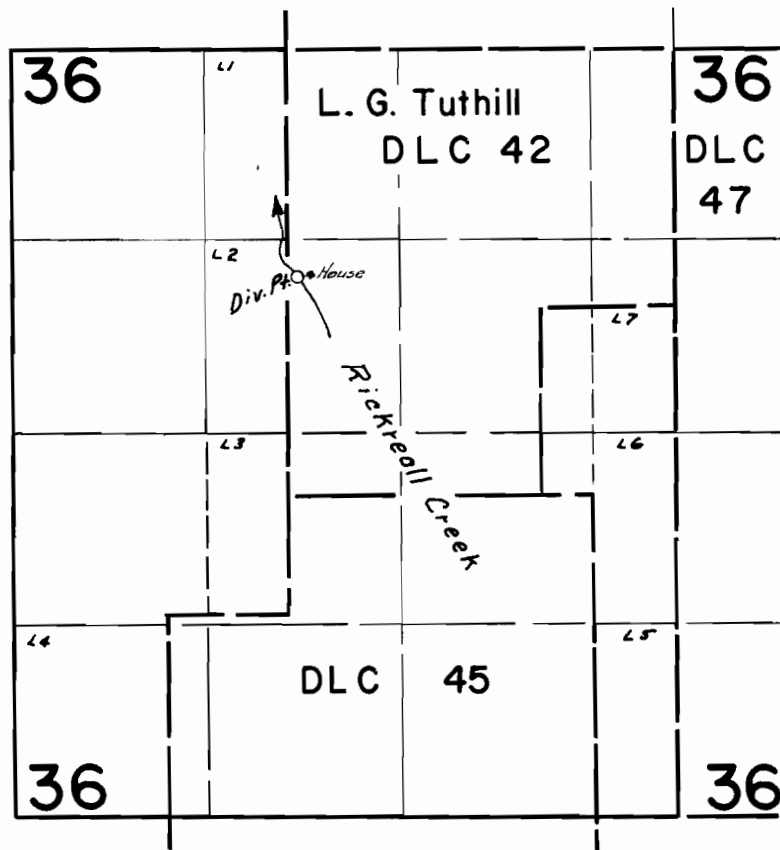

## FINAL PROOF SURVEY UNDER

Application No. 39460... Permit No. 29388...  
IN NAME OF

**ALBERT & ALTHEA BURELBACH**

Surveyed Sept. 24, 1964., by *C. J. Gardner*...

THIS MAP IS FOR ASSESSMENT AND TAXATION PURPOSES ONLY

N.E.1/4 N.W.1/4 SEC. 36 T.7S. R.6W. W.M.

7.6.36BA

Polk County

1" = 100'

RD. NO. 7604

See Map 7.6.25

MARTIN

NO. 8621

Canceled No.

None

LAUTERMANS  
LACROIX HOME  
SUMMER TRACTS

2-4

ROAD

10.00

10.27

See Map 7.6.36

See Map 7.6.36

2/14/2019

7.6.36BA

500  
1.12 AC

300  
0.97 AC

100  
0.49 AC

601

2

3

4

5

6

7

8

9

10

11

12

13

14

15

16

17

18

19

20

21

22

INITIAL POINT I.P.

258.40

S89°30'00"W

47.80

S89°30'00"E

212.74

S89°30'00"W

212.74

S89°30'00"E

122.21

(126.82)

S89°30'00"W

122.21

S89°30'00"E

122.49

(121.96)

N89°30'00"E

122.06

(121.56)

N89°30'00"W

129.49

S89°30'00"E

129.49

S89°30'00"W

100.00

S89°30'00"E

62.00

N89°30'00"E

62.00

S89°30'00"W

1048.40

S89°30'00"E

9816.00

S89°30'00"W

1048.40

S89°30'00"E

9816.00

S89°30'00"W

1048.40

S89°30'00"E

9816.00

S89°30'00"W

1048.40

S89°30'00"E

9816.00

S89°30'00"W

1048.40

S89°30'00"E

9816.00

S89°30'00"W

1048.40

S89°30'00"E

9816.00

S89°30'00"W

1048.40

S89°30'00"E

9816.00

S89°30'00"W

1048.40

S89°30'00"E

9816.00

S89°30'00"W

1048.40

S89°30'00"E

9816.00

S89°30'00"W

1048.40

S89°30'00"E

9816.00

S89°30'00"W

1048.40

S89°30'00"E

9816.00

S89°30'00"W

1048.40

S89°30'00"E

9816.00

S89°30'00"W

1048.40

S89°30'00"E

9816.00

S89°30'00"W

1048.40

S89°30'00"E

9816.00

S89°30'00"W

1048.40

S89°30'00"E

9816.00

S89°30'00"W

1048.40

S89°30'00"E

9816.00

S89°30'00"W

1048.40

S89°30'00"E

9816.00

S89°30'00"W

1048.40

S89°30'00"E

9816.00

S89°30'00"W

1048.40

S89°30'00"E

9816.00

S89°30'00"W

1048.40

S89°30'00"E

9816.00

S89°30'00"W

1048.40

S89°30'00"E

9816.00

S89°30'00"W

1048.40

S89°30'00"E

9816.00

S89°30'00"W

1048.40

S89°30'00"E

9816.00

S89°30'00"W

1048.40

S89°30'00"E

9816.00

S89°30'00"W

1048.40

S89°30'00"E

9816.00

S89°30'00"W

1048.40

S89°30'00"E

9816.00

S89°30'00"W

1048.40

S89°30'00"E

9816.00

S89°30'00"W

1048.40

S89°30'00"E

9816.00

S89°30'00"W

1048.40

S89°30'00"E

9816.00

S89°30'00"W

1048.40

S89°30'00"E

9816.00

S89°30'00"W

1048.40

S89°30'00"E

9816.00

S89°30'00"W

1048.40

S89°30'00"E

9816.00

S89°30'00"W

1048.40

S89°30'00"E

9816.00

S89°30'00"W

1048.40

S89°30'00"E

9816.00

S89°30'00"W

1048.40

S89°30'00"E

9816.00

S89°30'00"W

1048.40

S89°30'00"E

9816.00

S89°30'00"W

1048.40

S89°30'00"E

9816.00

S89°30'00"W

1048.40

S89°30'00"E

9816.00

S89°30'00"W

1048.40

S89°30'00"E

9816.00

S89°30'00"W

1048.40

S89°30'00"E

9816.00

S89°30'00"W

1048.40

S89°30'00"E

9816.00

S89°30'00"W

1048.40

S89°30'00"E

9816.00

S89°30'00"W

1048.40

S89°30'00"E

9816.00

S89°30'00"W

1048.40

S89°30'00"E

9816.00

S89°30'00"W

1048.40

S89°30'00"E

9816.00

S89°30'00"W

1048.40

S89°30'00"E

9816.00

S89°30'00"W

1048.40

S89°30'00"E

9816.00

S89°30'00"W

1048.40

S89°30'00"E

9816.00

S89°30'00"W

1048.40

S89°30'00"E

9816.00

S89°30'00"W

1048.40

S89°30'00"E

9816.00

S89°30'00"W

1048.40

S89°30'00"E

9816.00

S89°30'00"W

1048.40

S89°30'00"E

9816.00

S89°30'00"W

1048.40

S89°30'00"E

9816.00

S89°30'00"W