

MAP OF WARMSPRINGS RESERVOIR

LOCATED IN
T. 22 & 23 S. R. 36 & 37 E WM
OREGON

WARMSPRINGS IRRIGATION DISTRICT VALE, OREGON.

J. H. LEWIS, ENGINEER-MANAGER. A. J. WILEY, CONSULTING ENGINEER.
- BOARD OF DIRECTORS -
GEO. McLAUGHLIN. REX MARQUIS, PRES. R. H. DE ARMOND.

SURVEYED AND DRAWN BY W. M. L. STUBBE. NOVEMBER, 4th, 1919.
SCALE - 1 INCH = 1000 FEET.

STATE OF OREGON,
COUNTY OF MALHEUR, 1919:
John H. Lewis, being duly sworn, says he is the chief engineer of the Warm Springs Irrigation District; that the survey of said District's reservoir is described as follows: Beginning at a point, 476° 20' E. a distance of 6288 feet from the corner common to sections 7 and 8 T. 23 S. R. 37 E. of Willamette Meridian and sections 12 and 13 T. 23 S. R. 36 E. of Willamette Meridian, said point being the Initial and Terminal point of survey, described fully in the accompanying field notes, containing a total area of 4223 acres, and a capacity of 170,000 acre feet; was made under his direction as chief engineer of the Warm Springs Irrigation District and under his authority, commenced on the 17th day of July, 1919 and ending on the 3rd day of September, 1919, and that the survey of said reservoir accurately represents a level line, which is the proposed water line of said reservoir, and that such survey is accurately represented upon this map and by the accompanying field notes. And so lake or lake bed, no stream or stream bed, is used for the said reservoir except as shown on this map.

John H. Lewis
Chief Engineer.
Sworn and subscribed to before me this 4th day of November, 1919.
Chas. S. Batchelor
Notary Public for State of Oregon.
My commission expires July 24, 1920.

STATE OF OREGON,
COUNTY OF MALHEUR, 1919:
I, Rex Margus, do hereby certify that I am President of the Warm Springs Irrigation District; that John H. Lewis, who subscribes to the accompanying affidavit, is the chief engineer of the Warm Springs Irrigation District; that the survey of said reservoir, as accurately represented on this map and by the accompanying field notes, was made under the authority of the Warm Springs Irrigation District; that the Warm Springs Irrigation District is duly authorized by law and regular proceedings thereunder to construct the said reservoir upon the location shown upon this map; that the reservoir as represented on this map and by the accompanying field notes, was adopted by the Warm Springs Irrigation District by resolution of its board of directors on the 4th day of November, 1919, as the definite location of the said reservoir described as follows: Beginning at a point, 476° 20' E. a distance of 6288 feet from the corner common to sections 7 and 8 T. 23 S. R. 37 E. of Willamette Meridian and sections 12 and 13 T. 23 S. R. 36 E. of Willamette Meridian, said point being the Initial and Terminal point of survey, described fully in the accompanying field notes, containing a total area of 4223 acres, and a capacity of 170,000 acre feet; and that no lake or lake bed, stream or stream bed, is used for the said reservoir except as shown on this map; and that the map has been prepared for the approval of the Secretary of the Interior, it being the intention of the Warm Springs Irrigation District to obtain the benefits of the Act of Congress approved March 3rd, 1891, entitled "An act to repeal timber culture laws, and for other purposes" and Section 2 of the act approved May 11th, 1898; and I further certify that the right of way herein described is desired for the main purpose of irrigation.

Rex Margus
President of the Warm Springs Irrigation District
M. G. Hope
Secretary

NOTE:
All public lands embraced within this reservoir right of way application have been withdrawn from entry under the provisions of the Act of June 17, 1902 (32 Stat. 366) being the U. S. Reclamation Service Act, and also from entry under the provisions of the Act of August 10, 1907, as shown upon the accompanying map, which information was taken from Map No. 912, page 66, of the printed Cooperative report on Malheur and Owyhee Projects. A petition accompanies this application requesting the restoration of these lands by the Secretary of the Interior from the U. S. Reclamation Service withdrawals at such time as the same lands are simultaneously included within the right of way withdrawal herein requested.

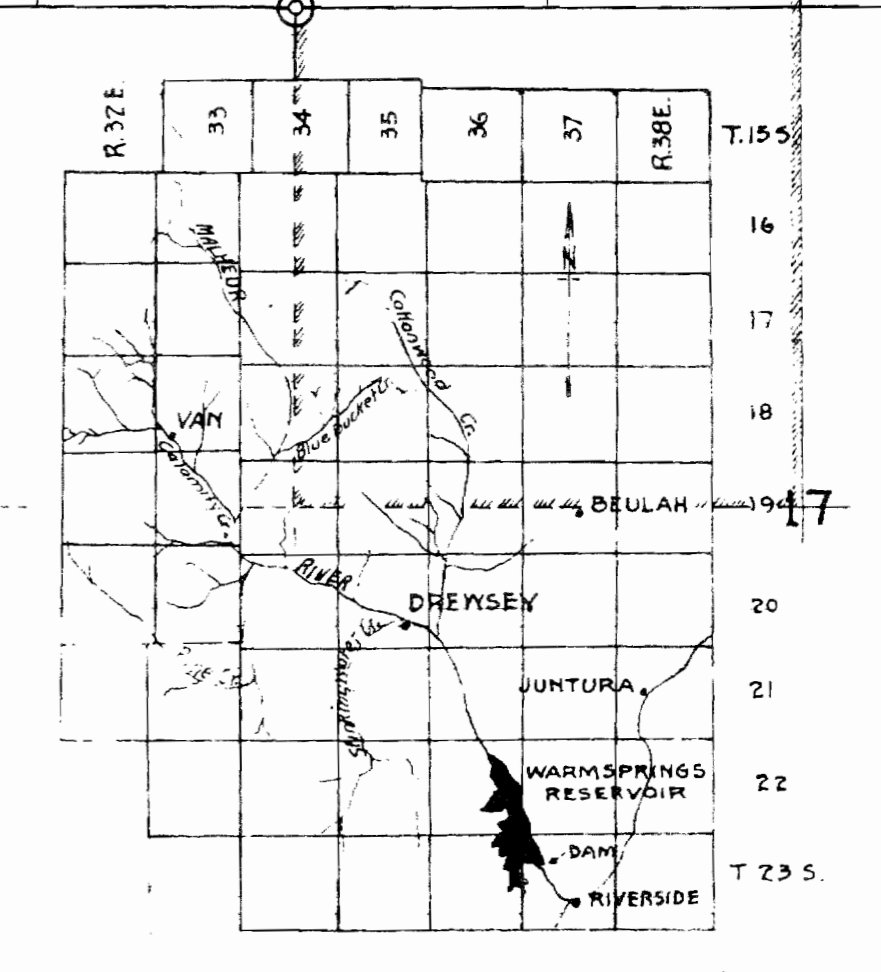
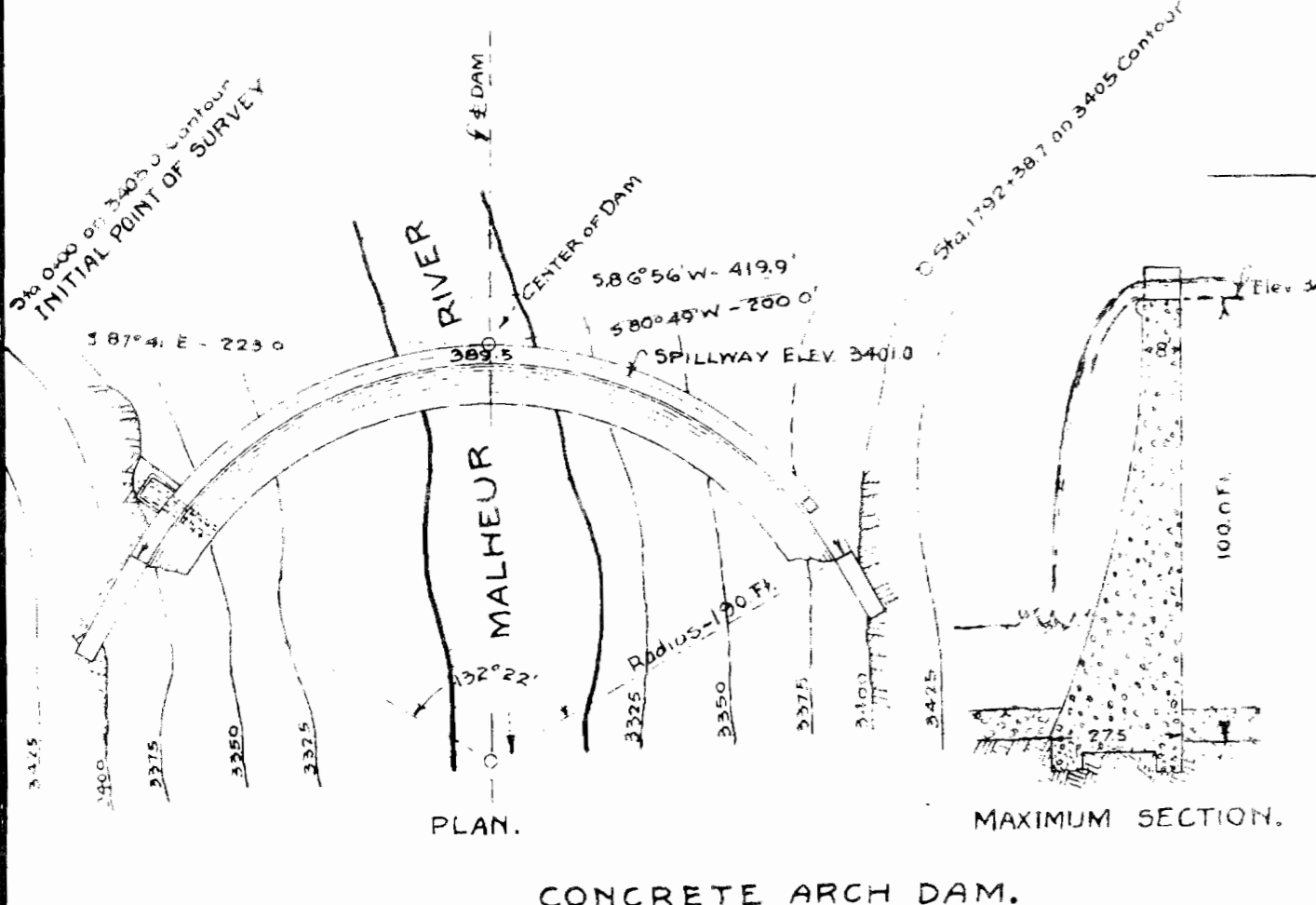
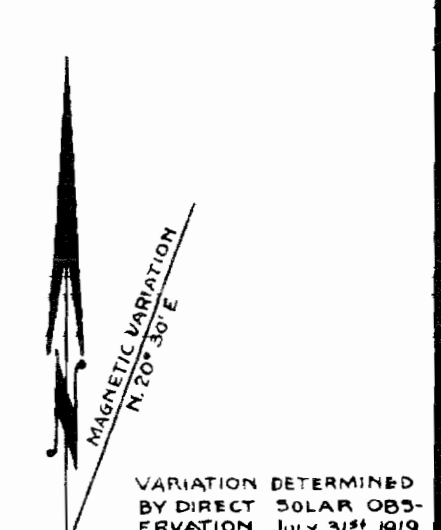
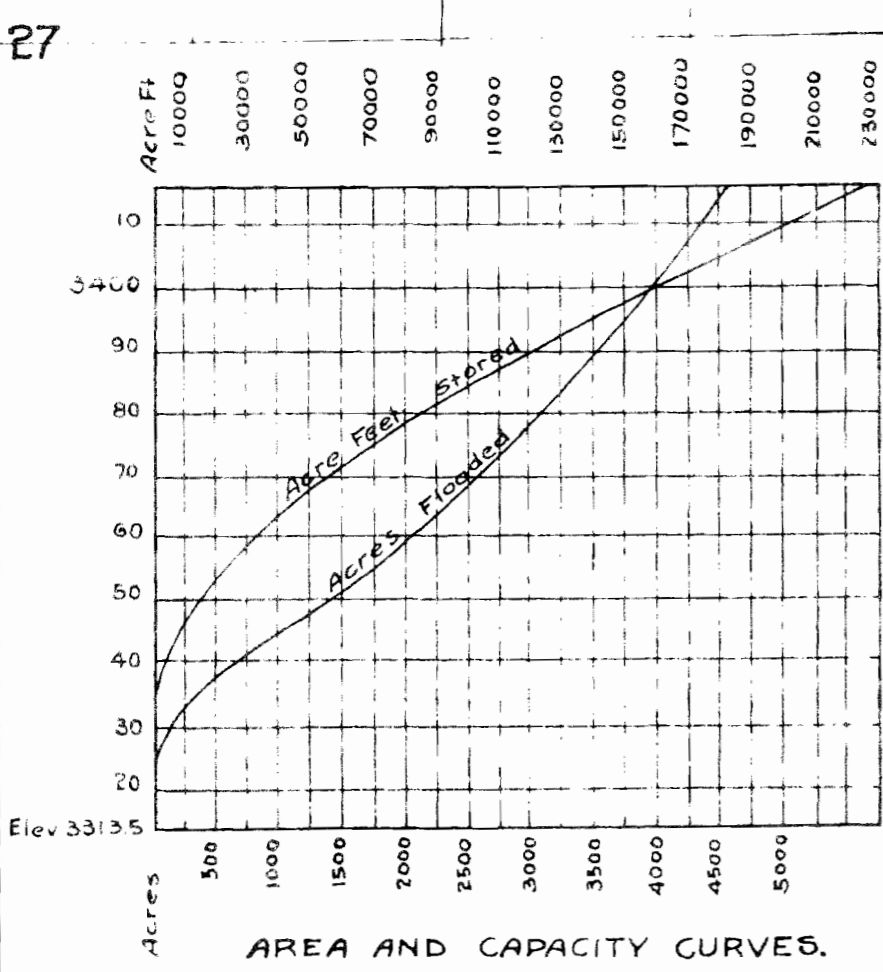
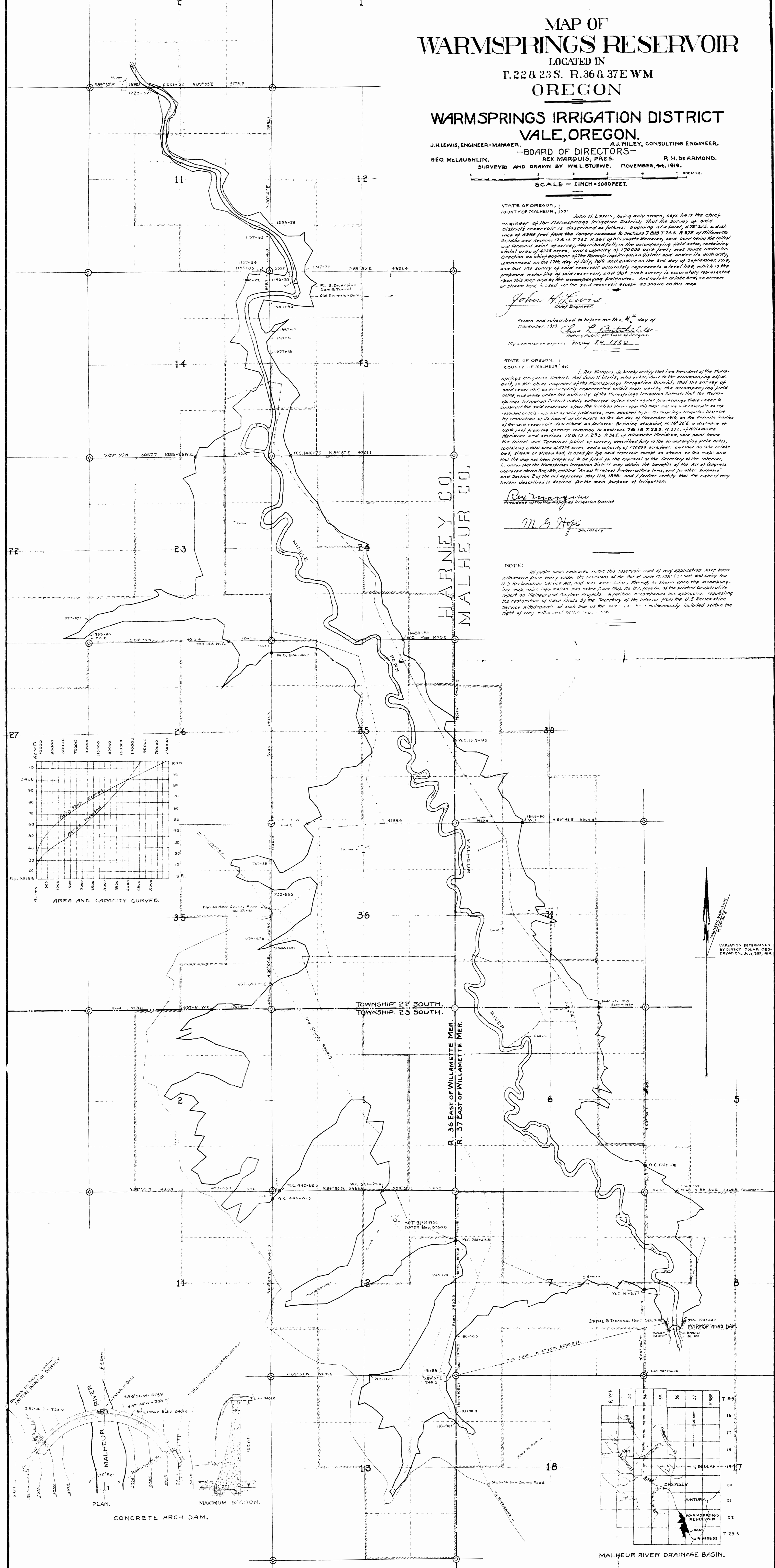

Application No. 3585
Reservoir Permit No. 457