

Township 38S, Range 5W

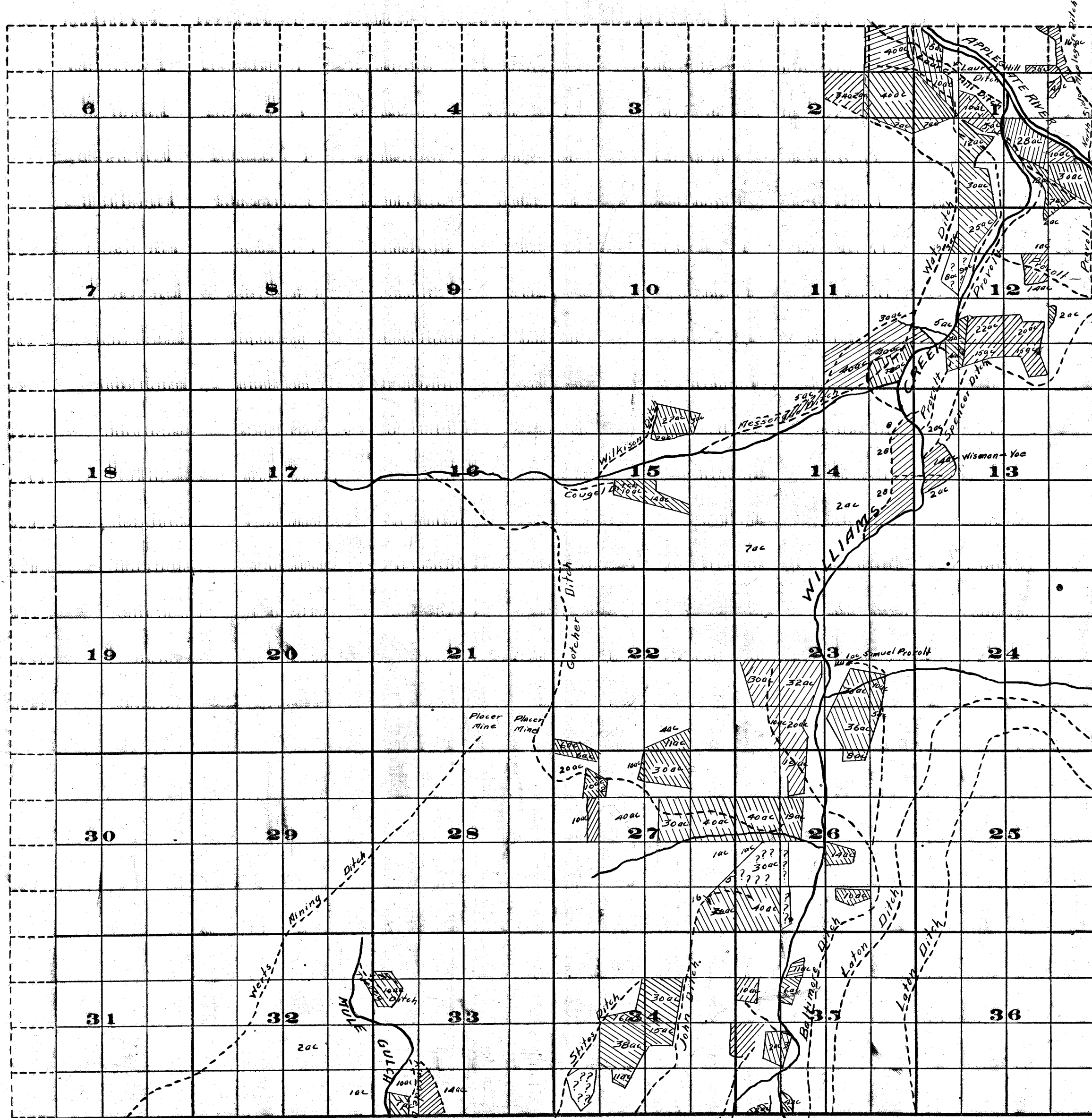

Survey J.S. McMahon April 1910

FROM OFFICE OF THE STATE ENGINEER, MALEM, OREGON

M.D.
D.F.M. 112-11

Scale of Feet.

Adjudication

Rogue River and Tributaries

John H. Lewis State Engr.

Examined Sept. 18, 1911