

# T. 36S. R. 14E. W.M.

S. Dr. Sprague  
Re. wells

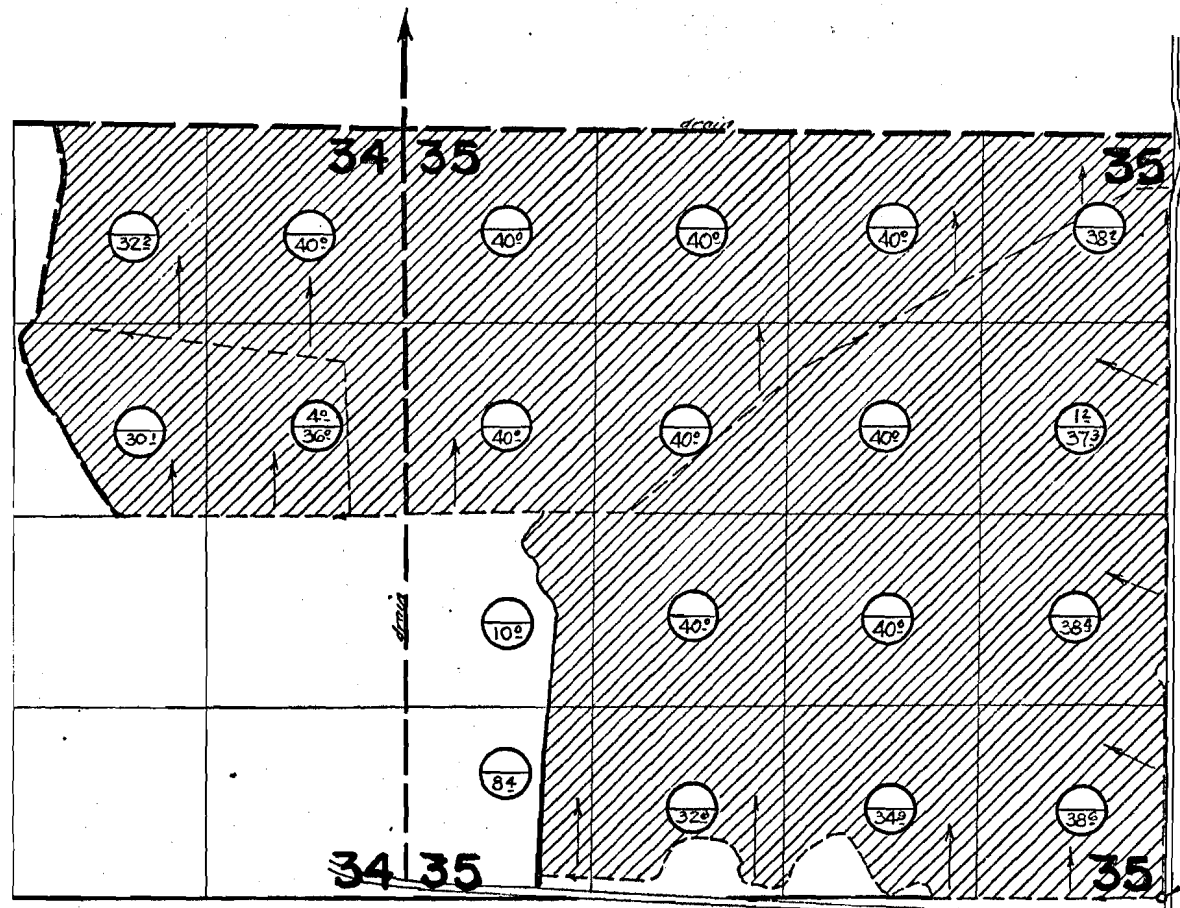

Primary  
Supplemental

WELL  
N. 9ft. and W. 43ft  
from SE Cor. 35

## FINAL PROOF SURVEY UNDER

Application No. G-1817... Permit No. G-1673  
IN NAME OF

ESTATE OF BASIL HALL

Surveyed July 22 1964, by *R. Jackson*