

T.1N. R.3W. W.M.

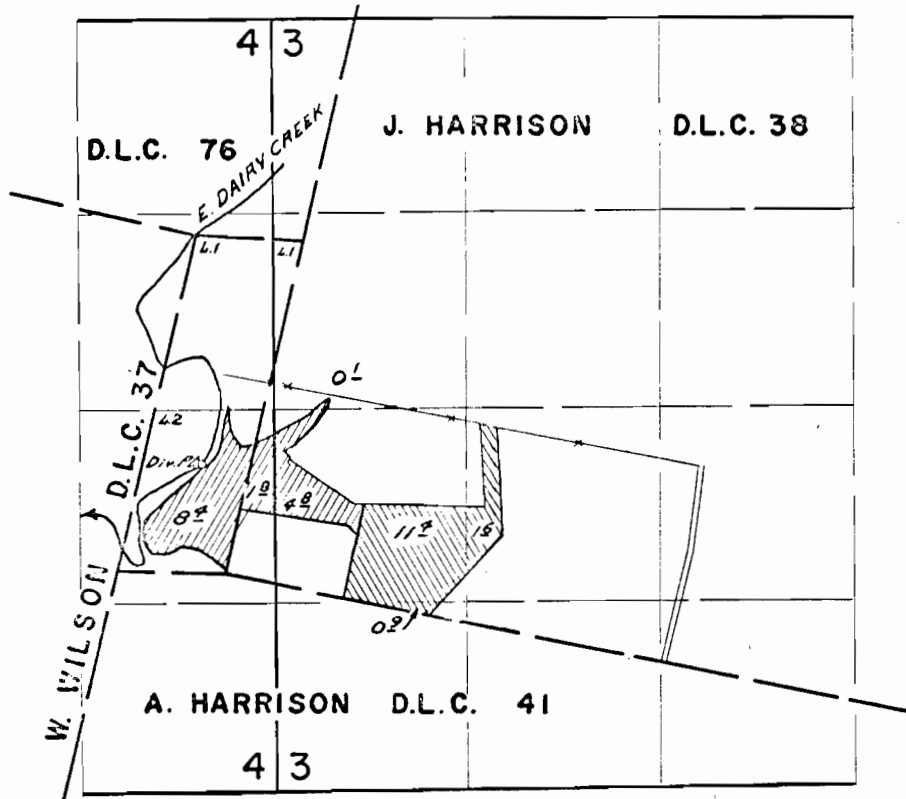

PER. NO. 27284
PER. NO. 28245

Div. PL LOCATED 160 FE. W. & 760 FE. N. FROM SW COR. D.L.C. 38

FINAL PROOF SURVEY
UNDER

34755 27284
Application No. 37924 Permit No. 28245
IN NAME OF

HOMER L. SIMANTEL

Surveyed MAY 22, 1964, by M. BISH