

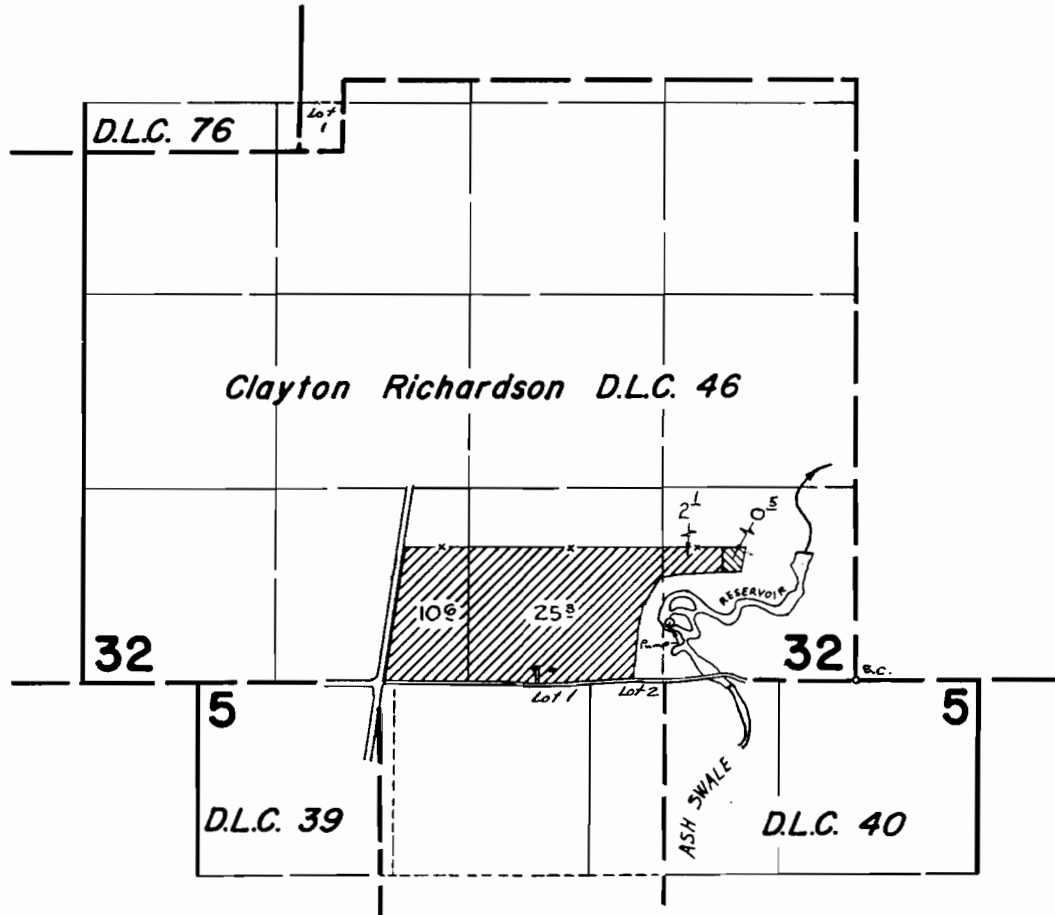



T.5&6 S. R.4 W. W.M.



Div. Pt. Loc: 870' N. 5' 350' W. from S.E. cor. Sec. 32

FINAL PROOF SURVEY UNDER

R-42709 R-4966
42829 32369
Application No. 39191 Permit No. 29144

 - Primary  - Supplemental
 - Primary

IN NAME OF

EARL E. COMPTON

Surveyed Nov. 2, 1965, by *R. Jackson*
May 29, 1973 R. G. MUCKEN