

T.6S. R.1W. W.M.

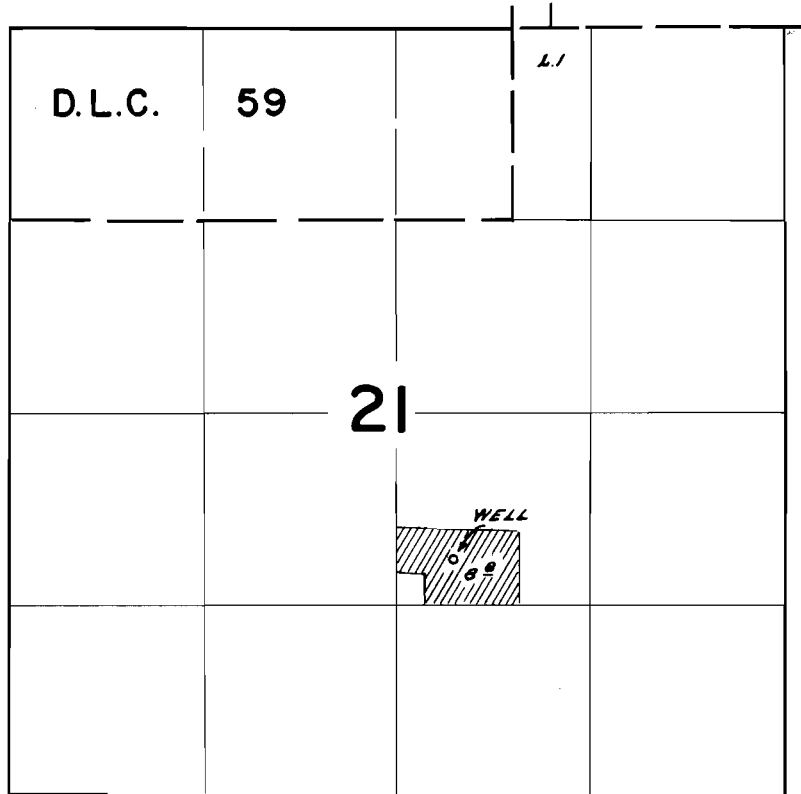

WELL LOCATED 300 FT. N.E. 390 FT. E. FROM S.W. COR. N.W. 1/4 SE. 1/4

FINAL PROOF SURVEY
UNDER

Application No. G-2158 Permit No. G-1986
IN NAME OF

LAWRENCE E. &, or MARGINE I. BOCHSLER

Surveyed AUG. 19, 1965, by C. GARDNER.