

T.1S. R.3E. W.M.

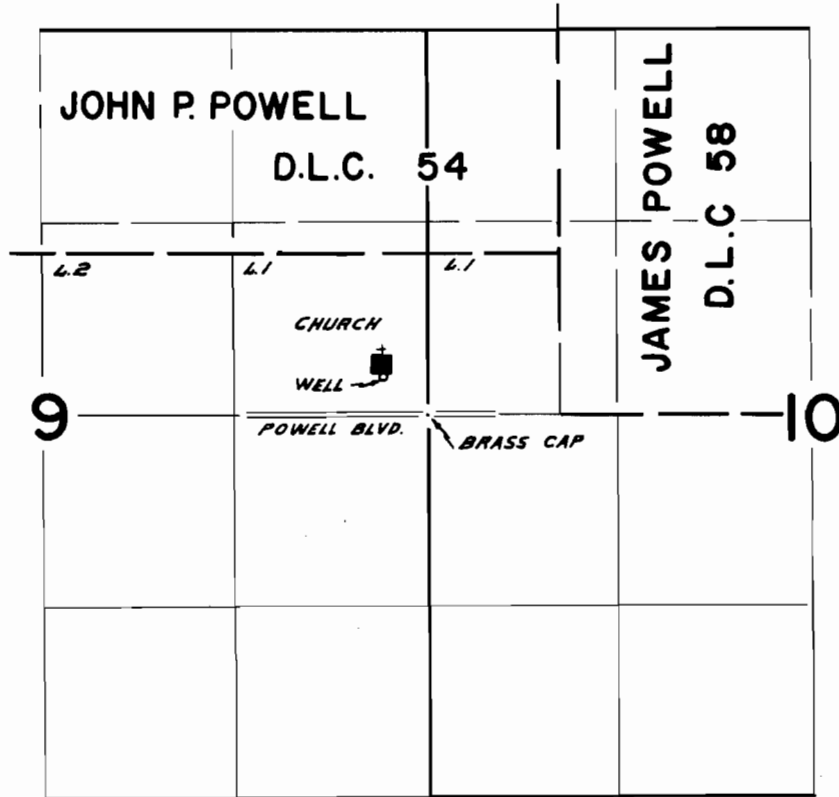

WELL LOCATED 250 FT. N.E. 300 FT. W. FROM E. 1/4 COR. SEC. 9

**FINAL PROOF SURVEY**  
UNDER

Application No. G-2748 Permit No. G-2553  
IN NAME OF

S.T. HENRY'S PARRISH

Surveyed SEPT. 10 1965, by C. GARDNER.