

T.14S. R.8W.W.M.

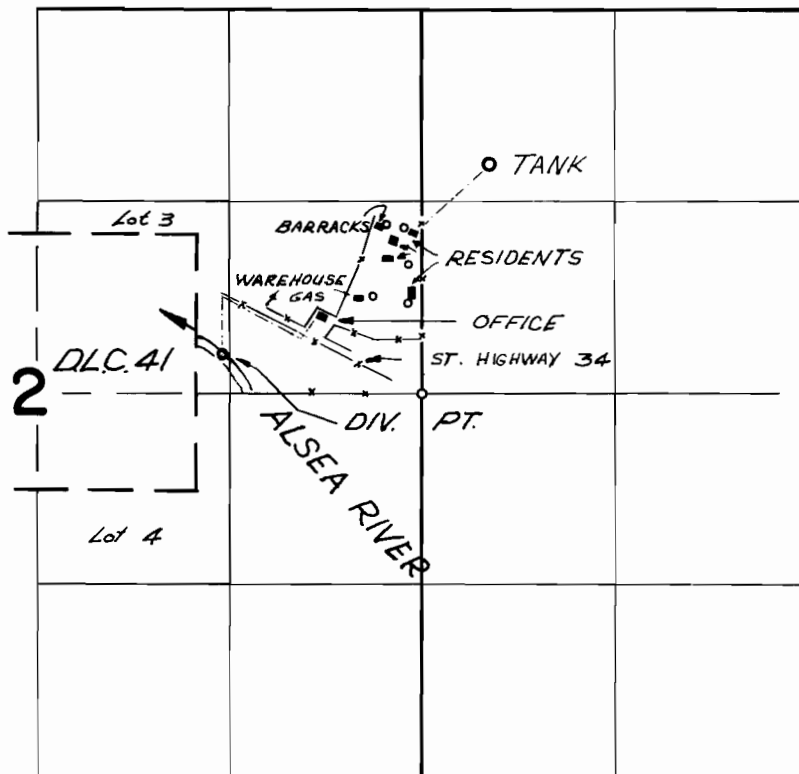

Diversion point located 1360 feet west and 270 feet north from East $\frac{1}{4}$ cor. Section 2

FINAL PROOF SURVEY
UNDER

Application No. 38287 Permit No. 29017

IN NAME OF
US FOREST SERVICE
SIUSLAW NATIONAL FOREST

Surveyed April 15 1966, by V. GARNER