

OFFICE OF STATE ENGINEER  
RECEIVED  
APR 19 1911  
SALEM, OREGON

I, J. L. Ringo, of Crescent Oregon do hereby certify that this map was made by me on April 14, 1911, and that it approximately represents the works described in the accompanying application, together with the approximate location of streams and other ditches in the immediate vicinity, and has written thereon the area in each smallest legal subdivision which it is proposed to irrigate.

J. L. Ringo  
Surveyor

Application No. 1368  
Irrigation Permit No. 94

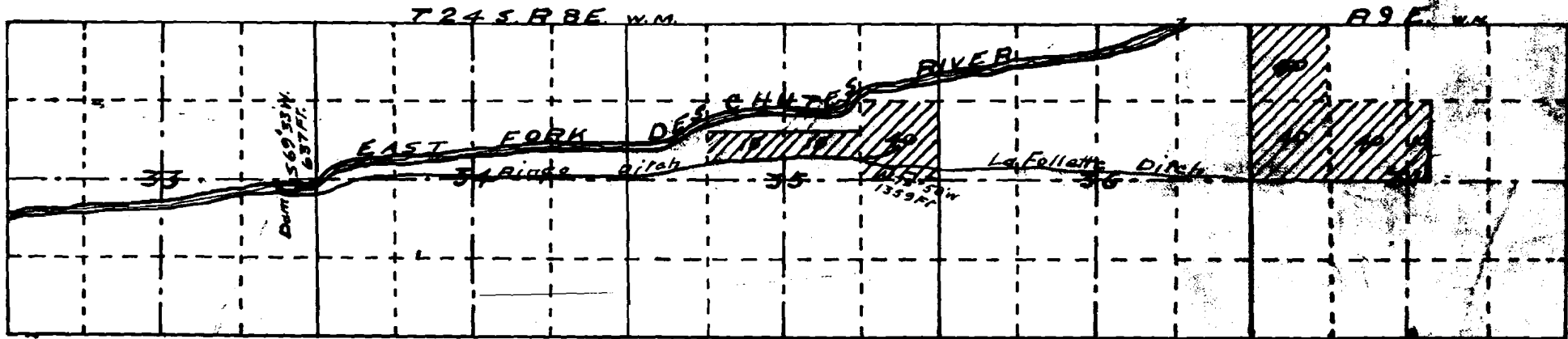

1392

76

C-3383