

T.1N. R.3E. W.M.

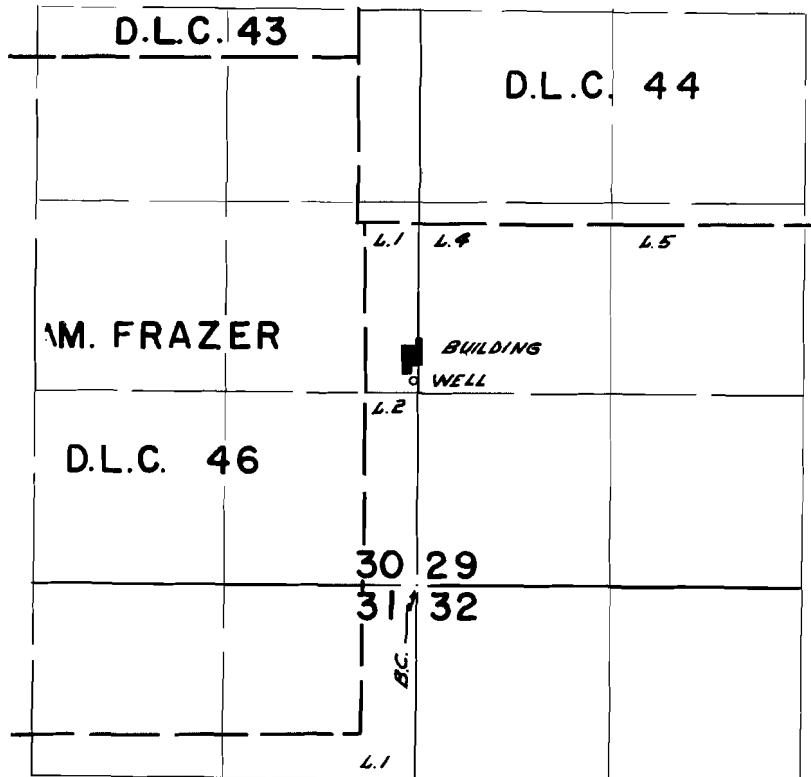

WELL LOCATED 140 FT. N. & 25 FT. W. FROM SE. COR. SEC. 30

FINAL PROOF SURVEY
UNDER

Application No. G-2953 Permit No. G-2747
IN NAME OF

JOHN DEERE COMPANY

Surveyed SEPT. 9 1965, by C. GARDNER