

T.27S.R.5W.W.M.

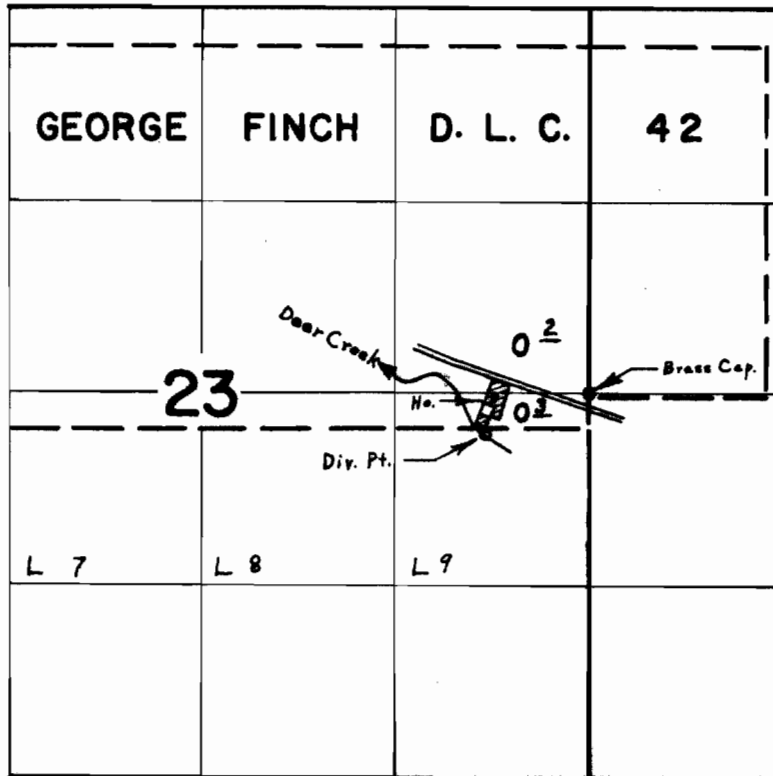

Div. Pt. Located 280' S. & 710' W. From E. $\frac{1}{4}$ Cor. Sec. 23

FINAL PROOF SURVEY UNDER

Application No. 41191 Permit No. 30699
IN NAME OF

NELLIE A. BRANTON

Surveyed May 17, 1966, by L. E. Gould