

T.36S.R.4W.W.M.

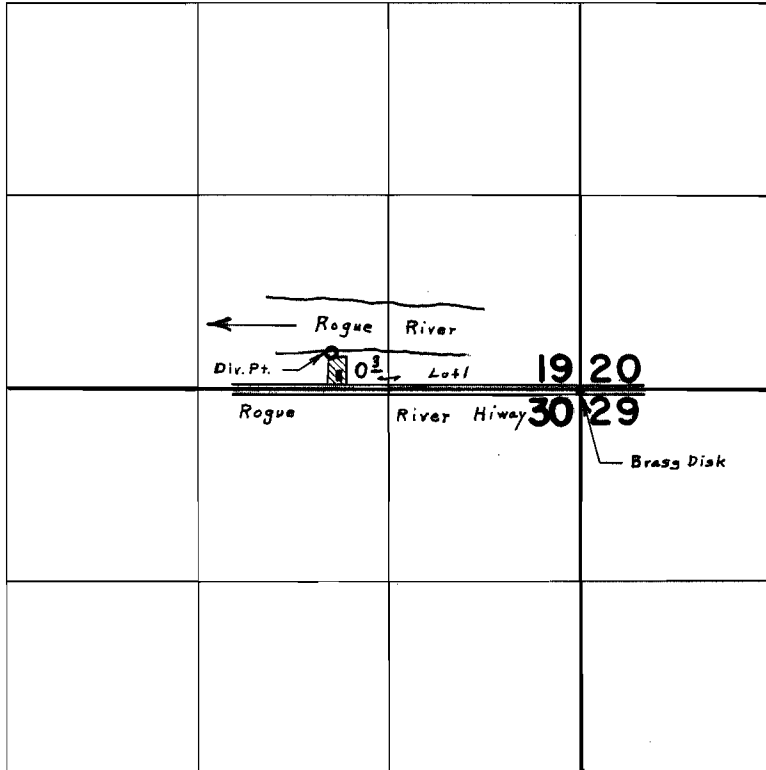

Div. Pt. Located 1720' W. & 250' N.
From S.E. Corner Section 19

FINAL PROOF SURVEY UNDER

Application No. 37701 Permit No. 28118
IN NAME OF

WILLIAM E. CUTTS

Surveyed June 8, 1966, by L. E. Gould