

T. 38 S. R. 4 W. W.M.

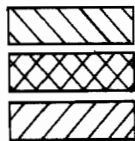
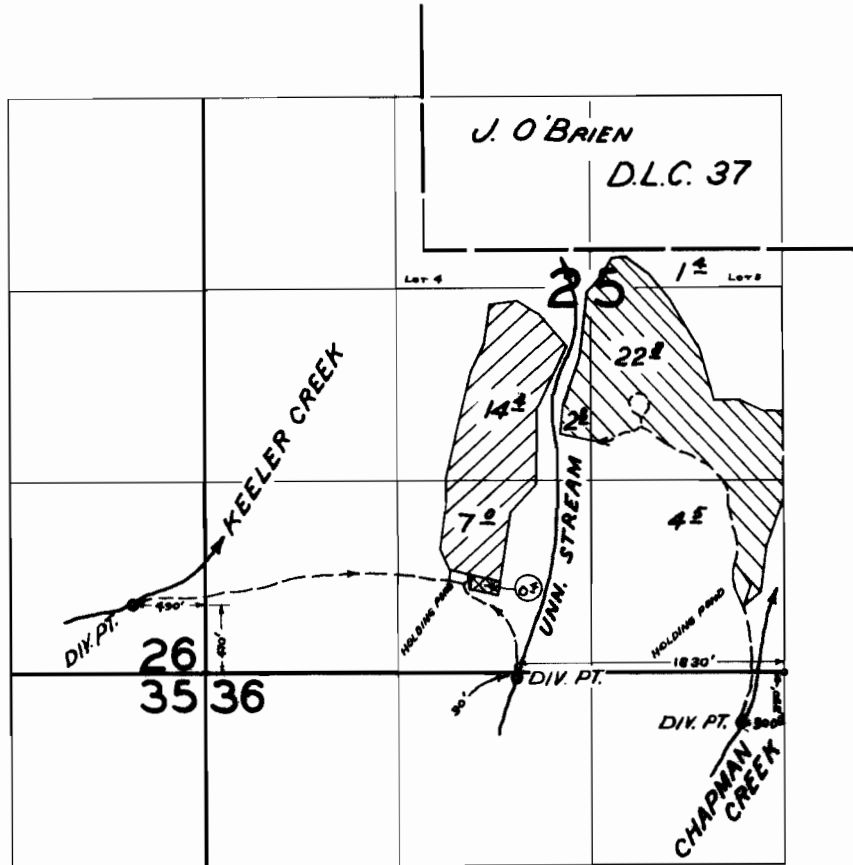

FLOODED FROM CHAPMAN CR.
FLOODED FROM UNN. STREAM
SPRINKLED FROM KEELER CR. & UNN. STREAM

FINAL PROOF SURVEY
UNDER

Application No. 30755 Permit No. 24228
IN NAME OF

FREDERICK H. LEADLEY

Surveyed JUN 26 1965, by C. GARDNER