

T. 27 S. R. 18 & 19 E. W.M.

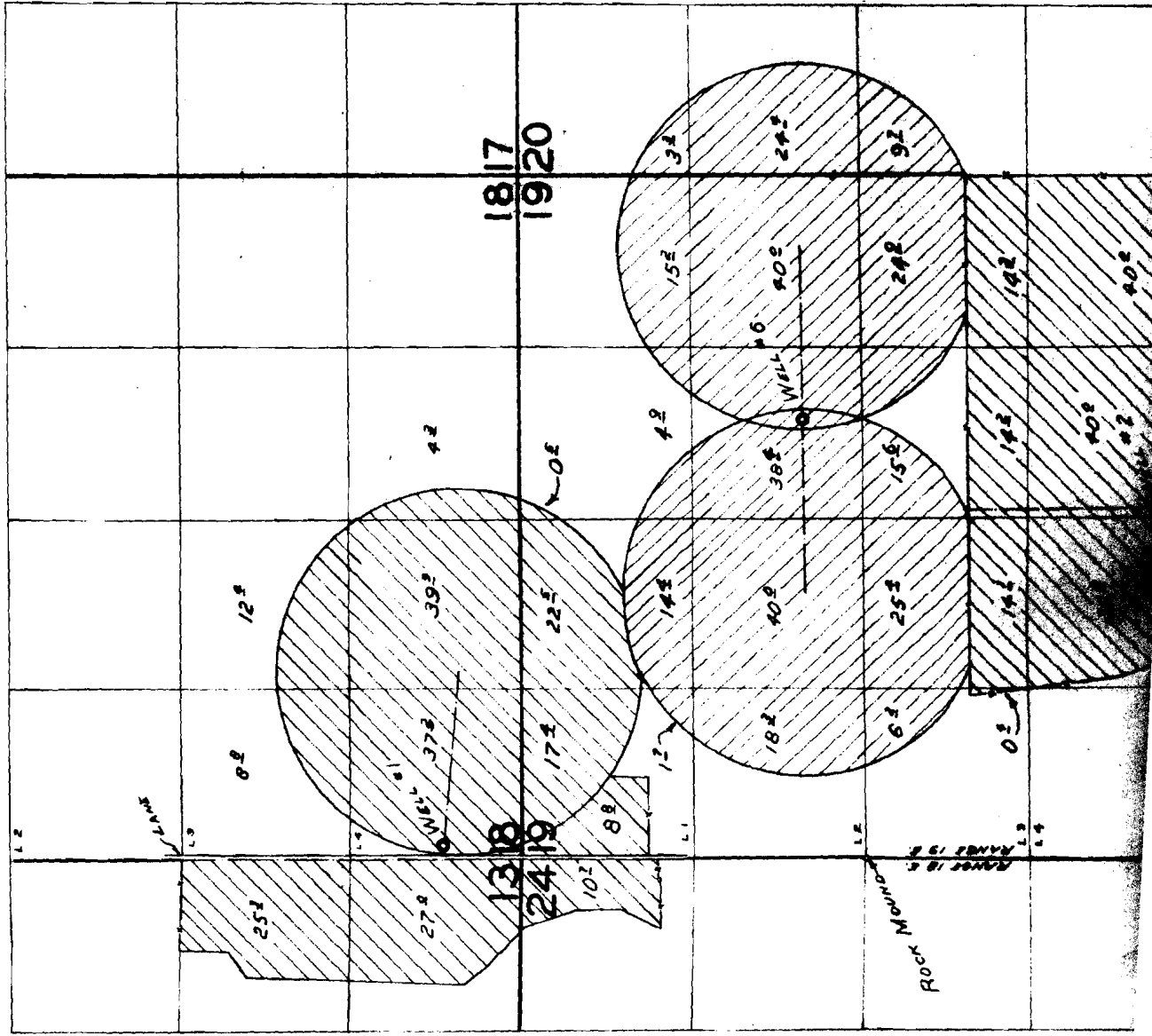

2500

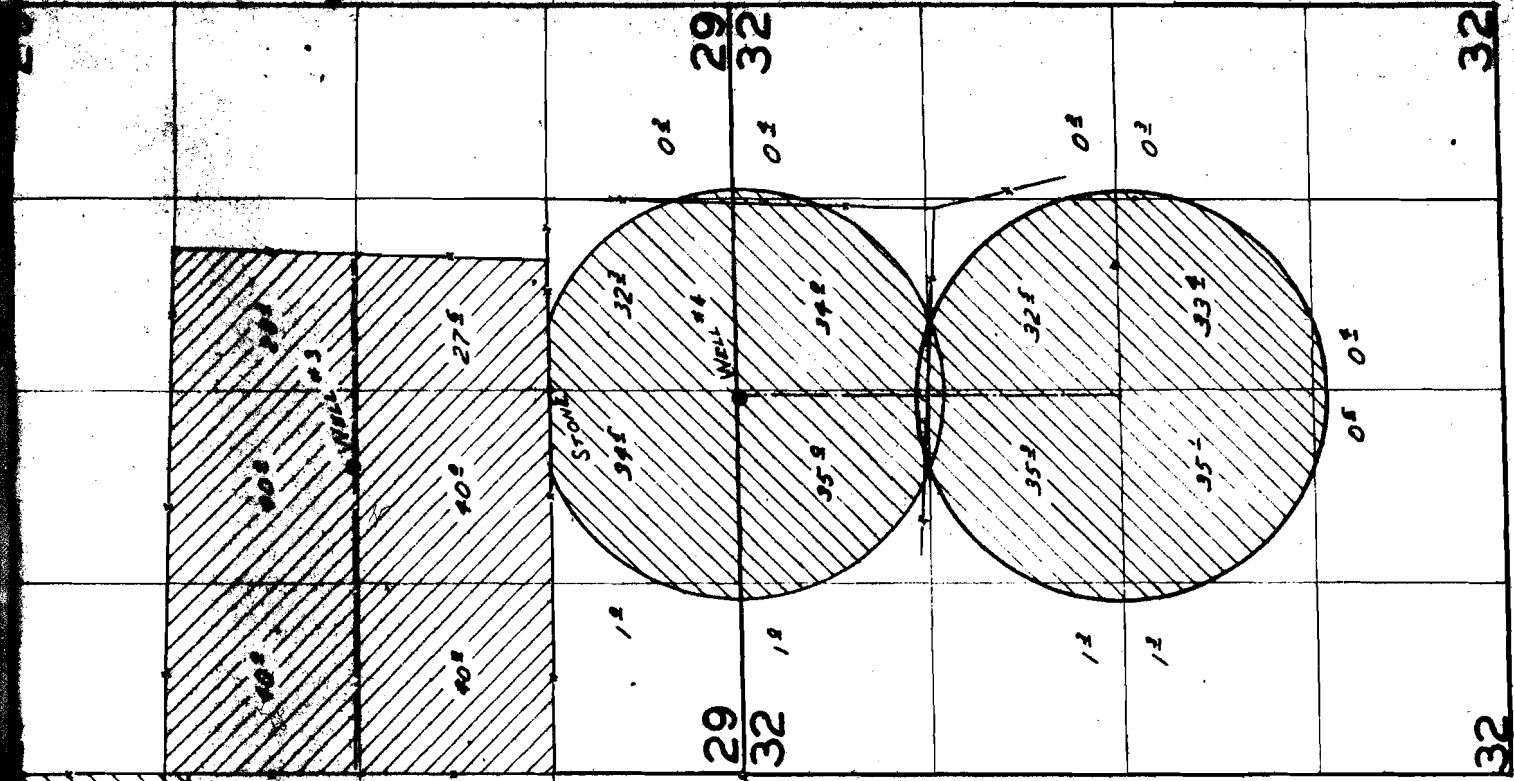

**FINAL PROOF SURVEY  
UNDER**

APPLICATION NO.	PERMIT NO.
G-776	G-662
G-777	G-676
G-728	G-697
G-727	G-696
G-2085	G-1915
G-2166	G-1997

IN NAME OF

**WEST SACRAMENTO ENTERPRISES INC.**

**SURVEYED** SEP 19, 1962 by C.R. BAKER  
SEP 9, 1964 by R. JACKSON

29 32 0.1 0.2 1.2 1.8 0.5 0.1 32