

T.36S.R.3W.W.M.

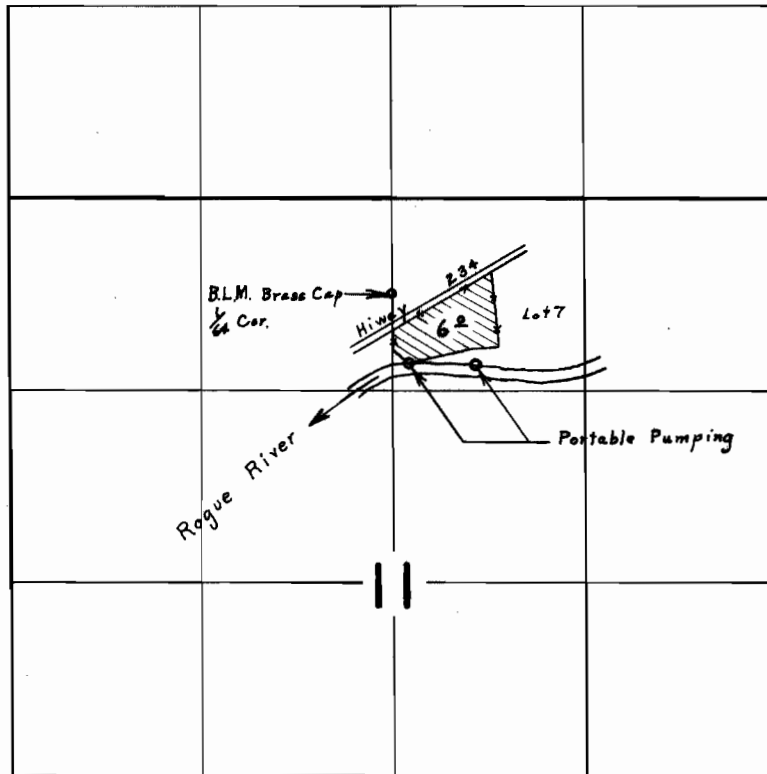

Portable Pumping Between Pts. Located 470'S. & 100'E., 500'S. & 570'E.
Both From N.W. Cor., S. $\frac{1}{2}$, N.W. $\frac{1}{4}$, N.E. $\frac{1}{2}$, Sec. 11

FINAL PROOF SURVEY UNDER

Application No. 38228 Permit No. 28483
IN NAME OF

C. L. EAKER

Surveyed June 2, 1966, by R. E. Gould