

T.34S.R.IW.W.M.

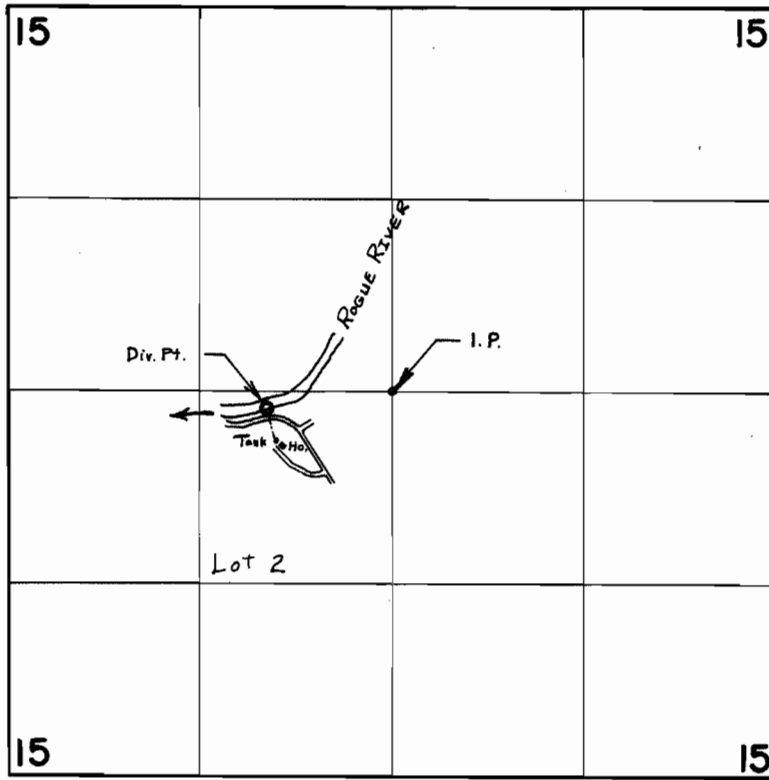

Div. Pt. Located 860' W. & 120' S. From Center Sec. 15

FINAL PROOF SURVEY
UNDER

Application No. 38824 Permit No. 28865
IN NAME OF

GEORGE W. & ADA MAY WILSON

Surveyed July 12 1966, by R. E. Gould