

6-1738

34282

14, T3N. R26E, W.M., UMATILLA COUNTY OREGON
FRANK WARREN

1 1/2" PIPE W/ BRASS
CAP N.E. SEC CORNER
MARKER WELL
LOCATION 2540' SOUTH
1520' WEST

11 12

14 13

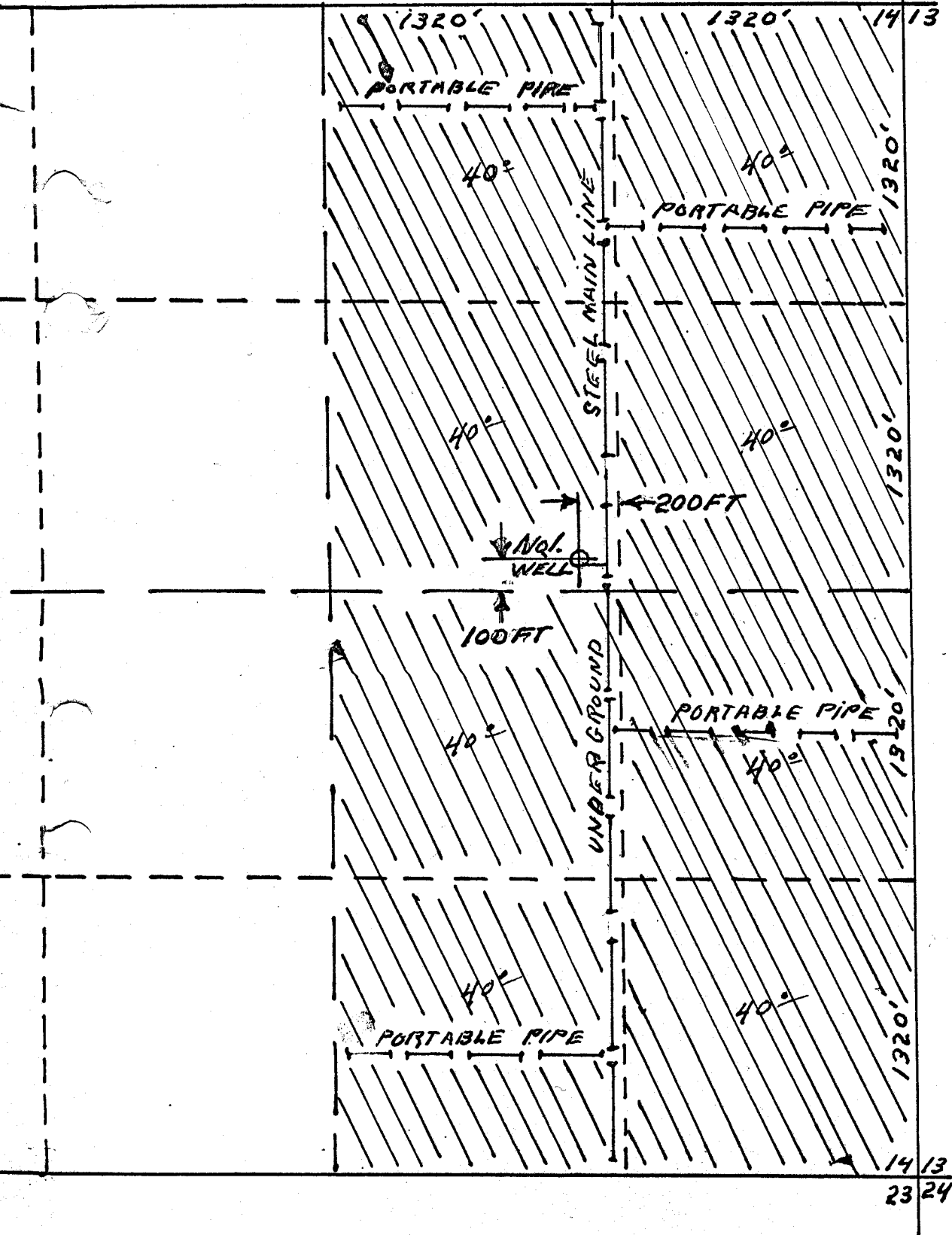

Application No. G-1896

Permit No. G-1720