

T.27 & 28S. R.11W. W.M.

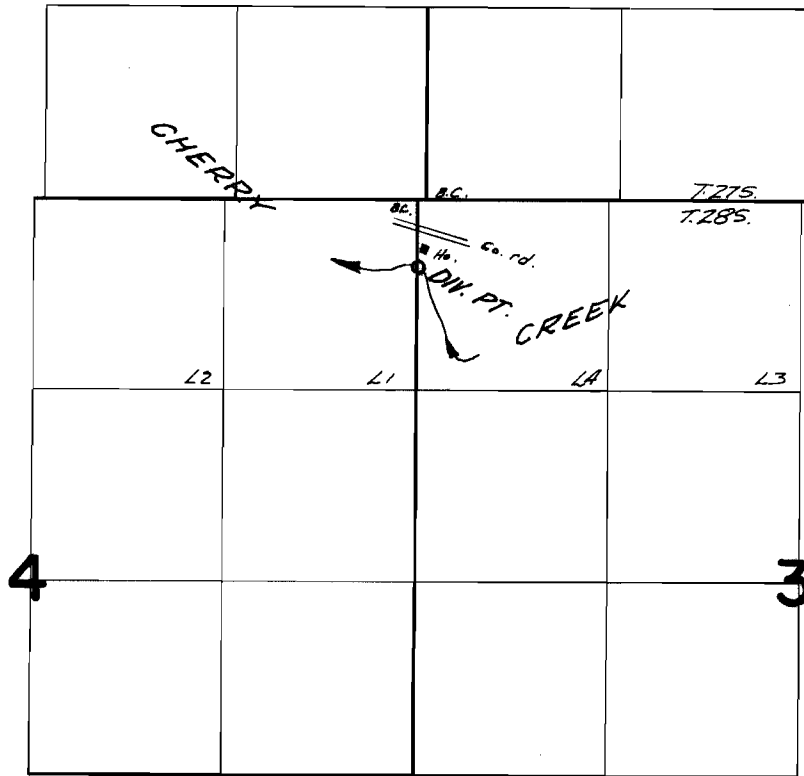

*Div. Pt located 460 ft. S. of S & E
from the NW cor. of Section 3*

FINAL PROOF SURVEY UNDER

Application No. 39462. Permit No. 29299.
IN NAME OF

HAROLD SHEPHERD

Surveyed Oct. 11, 1966, by V. GARNER