

T.34S.R.1W.W.M.

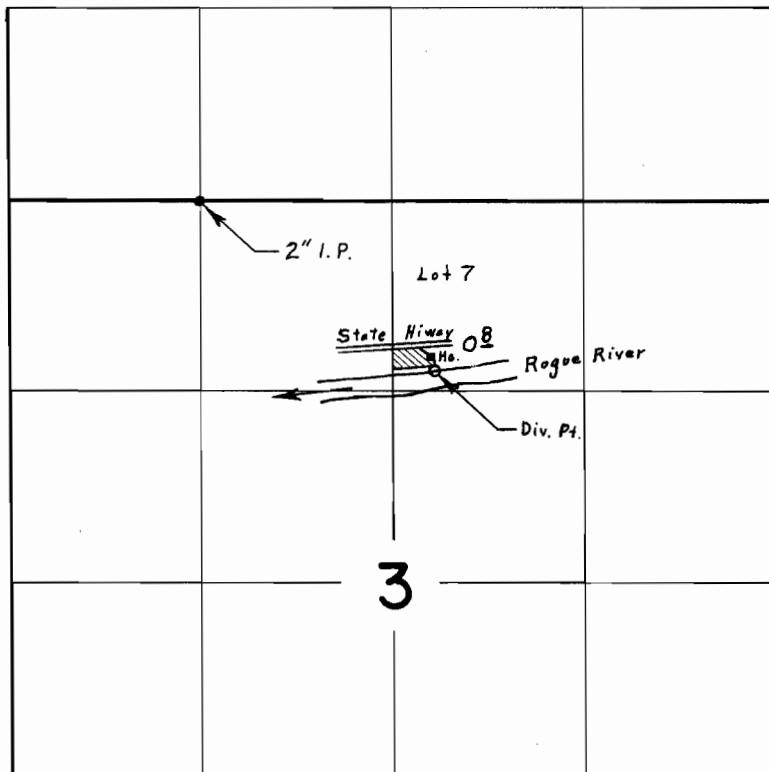

Div. Pt. Located 1610' E. & 1170' S. From NW. Cor. NE. $\frac{1}{4}$, NW. $\frac{1}{4}$ Sec. 3

FINAL PROOF SURVEY UNDER

Application No. 38279 Permit No. 28571
IN NAME OF

CARL DAWSON

Surveyed July 15, 1966, by L. E. Gould