

T.14S. R.8W. W.M.

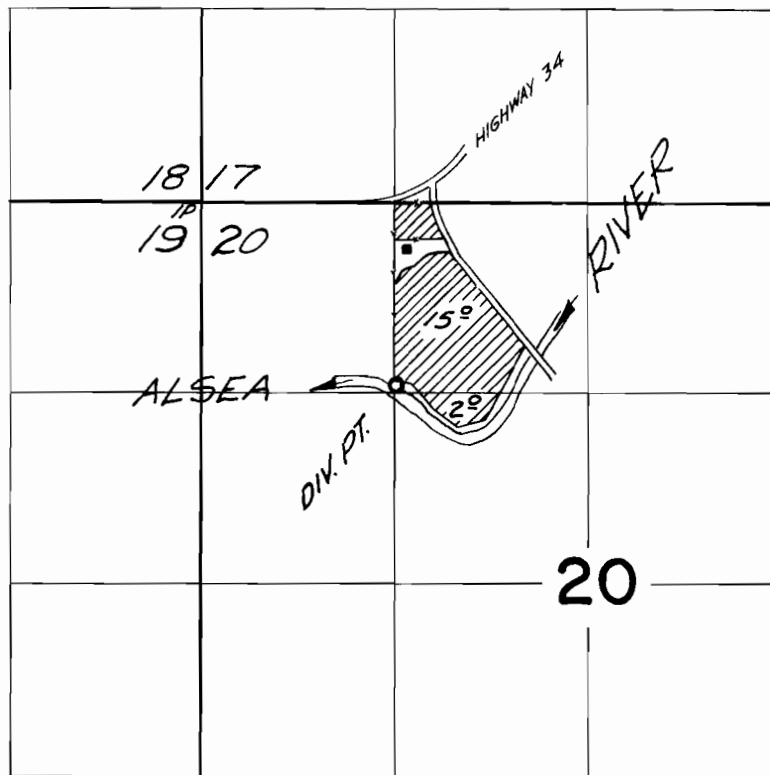

*Div. Pt. located 1250 ft. S. & 1340 ft. E.
from the NW cor. of Sec 20*

FINAL PROOF SURVEY
UNDER

Application No. 38691 Permit No. 28785
IN NAME OF

GUS KIRKBRIDE

Surveyed April 19 1966, by V. GARNER