

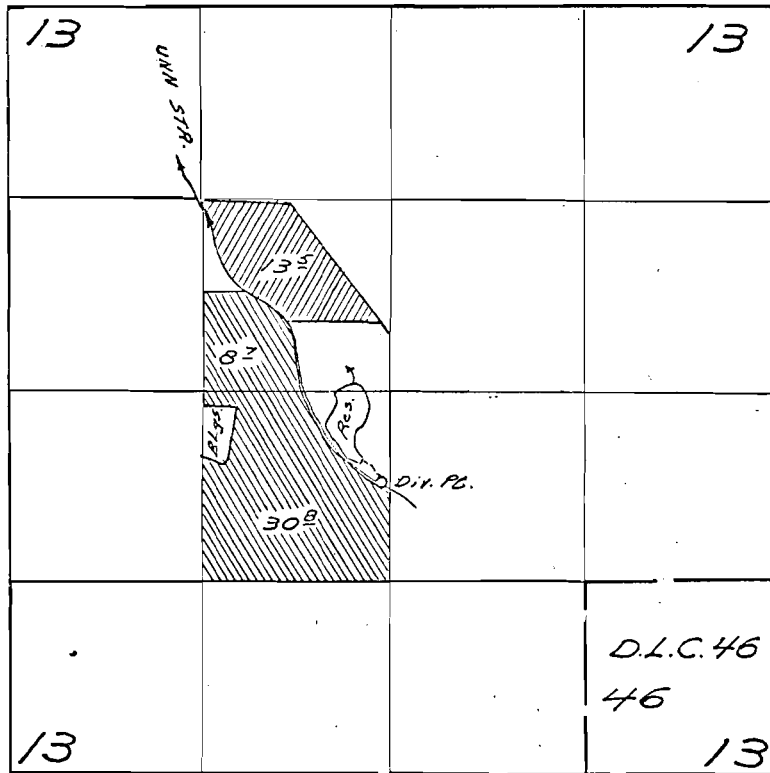

# T. 4 S. R. 1 E. W. M.



Div. Pl. Located 50 SE W. E 680 SE N. From SE Cor.  
NE 1/4 SW 1/4 Sec. 13

## FINAL PROOF SURVEY UNDER

37705                      28091                        
 R-40059                      R-4357  
 Application No. 40060... Permit No. 29857...                        
 IN NAME OF

Edward Butcher

Surveyed Oct. 19 19.66, by W. J. Ruppert