

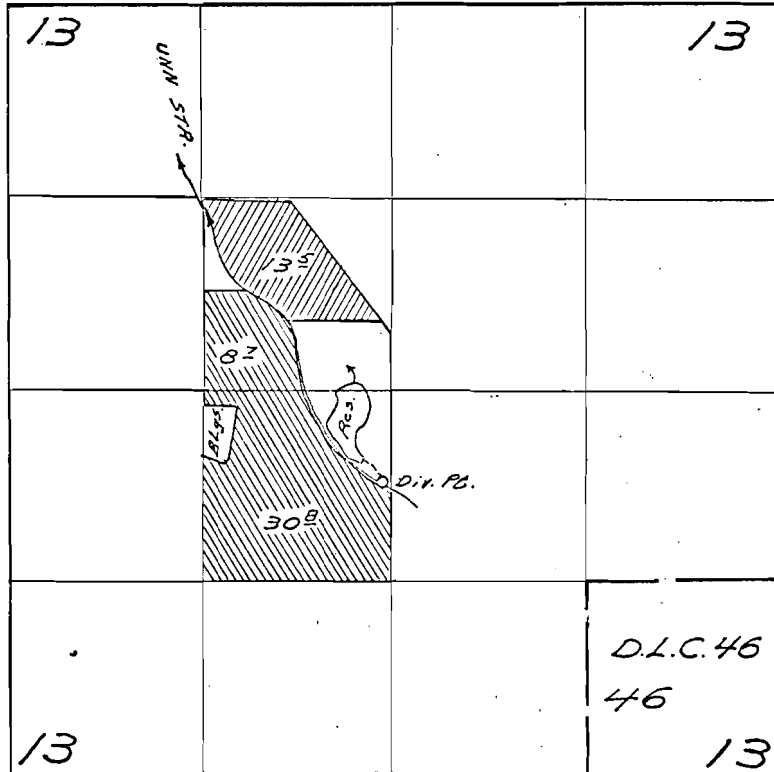

T. 4S. R. 1E. W.M.



Div. Pt. Located 50 ft W. & 680 ft N. From SE Cor.
NE 1/4 SW 1/4 Sec. 13

FINAL PROOF SURVEY UNDER

37705 28091 
R-40059 R-4357
Application No. ~~40060~~ Permit No. ~~29857~~ 
IN NAME OF

Edward Butcher

Surveyed Oct. 19 1966, by W. J. Ruppert