

T.29S. R.12W. W.M.

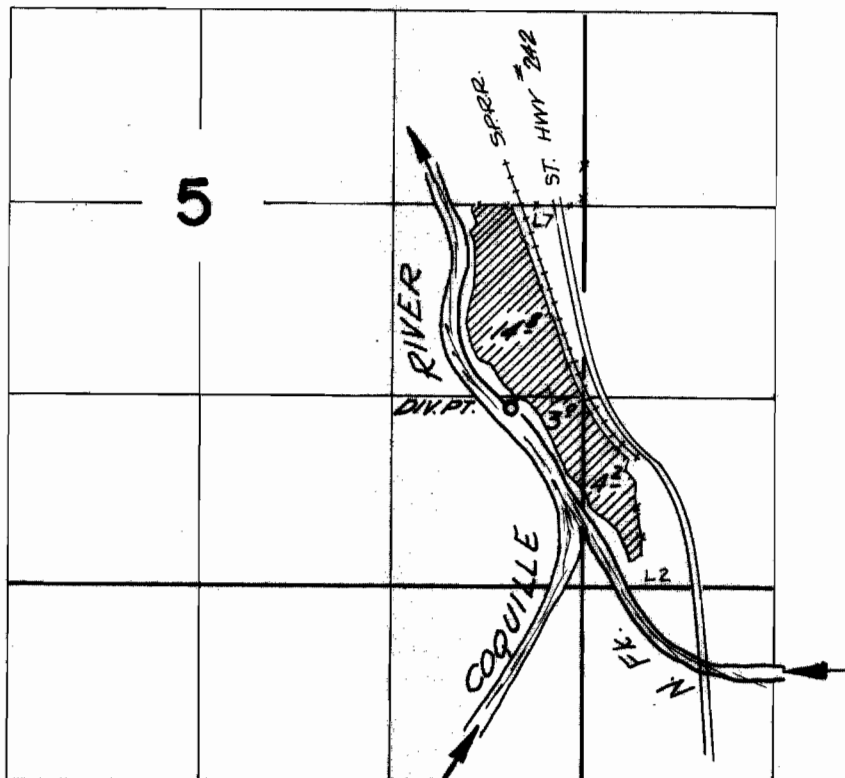

*Div. Pt. located 1400 ft. S. & 500 ft. W.
from the E $\frac{1}{4}$ cor of section 5*

FINAL PROOF SURVEY
UNDER

Application No. 35033 Permit No. 27438
IN NAME OF

CLYDE L. HEAD

Surveyed Oct. 12 1966, by V. GARNER