

T. 31 S. R. 15 W. W.M.

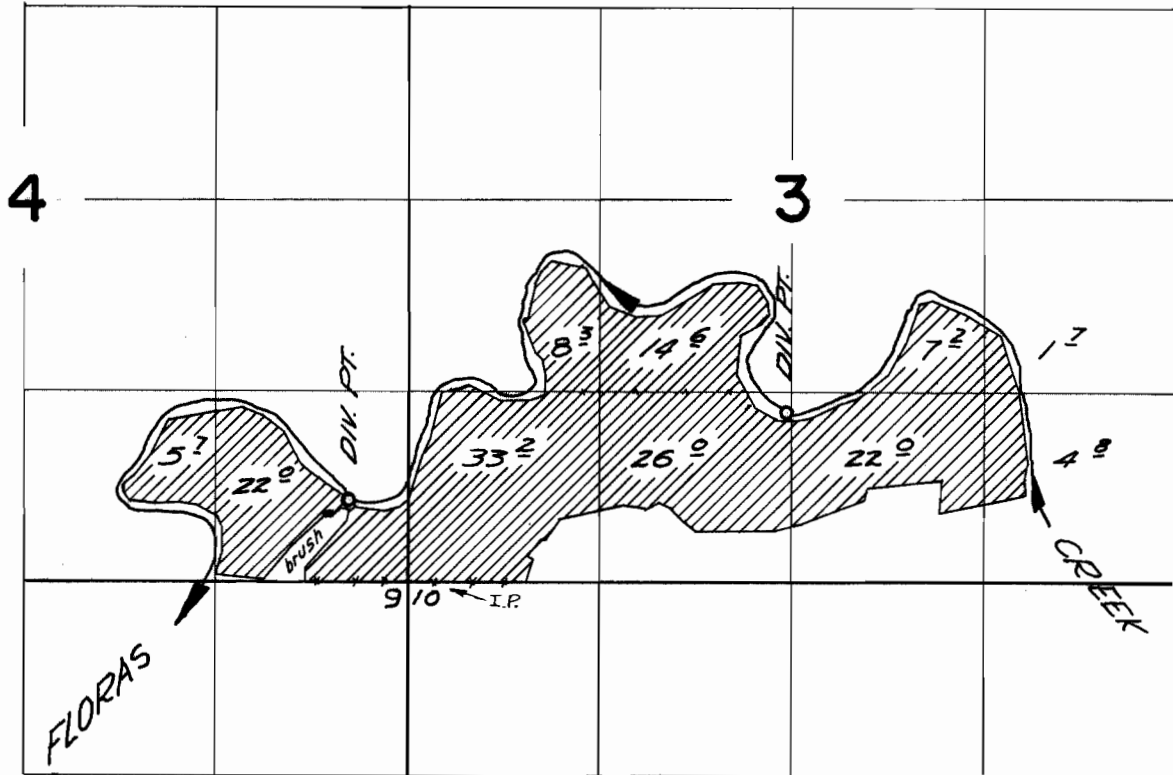

Div. Pts. located 1170 ft. N. & 2610 ft. E. ; 560 ft. N.  
& 410 ft. W., both from the S.W. corner of Section 3

**FINAL PROOF SURVEY**  
UNDER

Application No. 37364 Permit No. 28167  
IN NAME OF

LOWELL J. KREUTZER

Surveyed Sept. 15 1966, by V. GARNER