

# T.27 S. R.2&3 W. W.M.

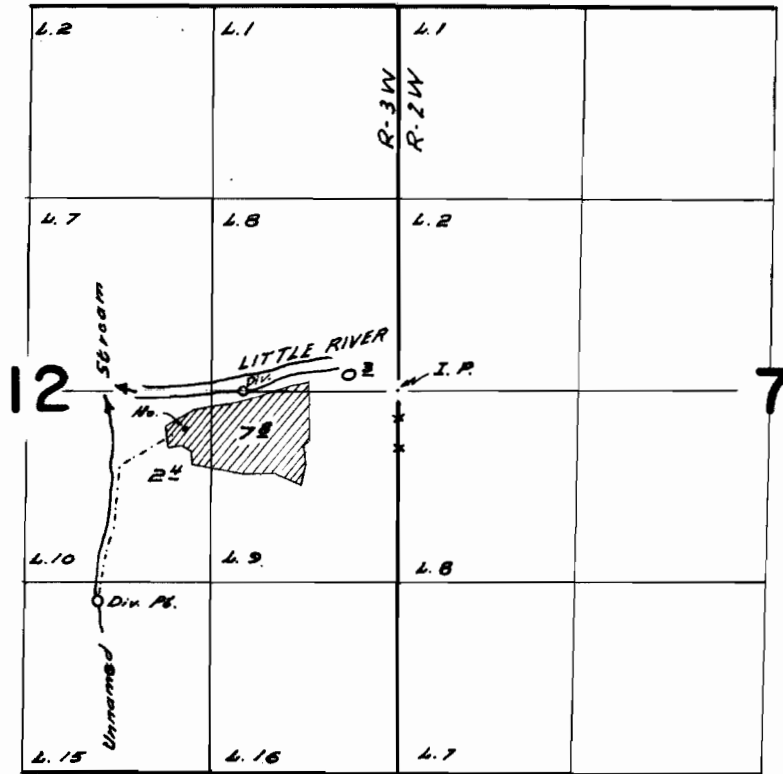

DIVERSION POINT FROM LITTLE RIVER 10 FT. N & 1060 FT. W.  
 DIVERSION POINT FROM UNN. STREAM 1440 FT. S & 2060 FT. W.  
 BOTH FROM E 1/4 COR. SEC. 12

## FINAL PROOF SURVEY UNDER

Application No. 40360 Permit No. 30091  
 IN NAME OF

DEIBERT B. JOHNSON

Surveyed JUNE 9 1967, by W.D. Ruppert