

T. 38 SR. 8 W. W.M.

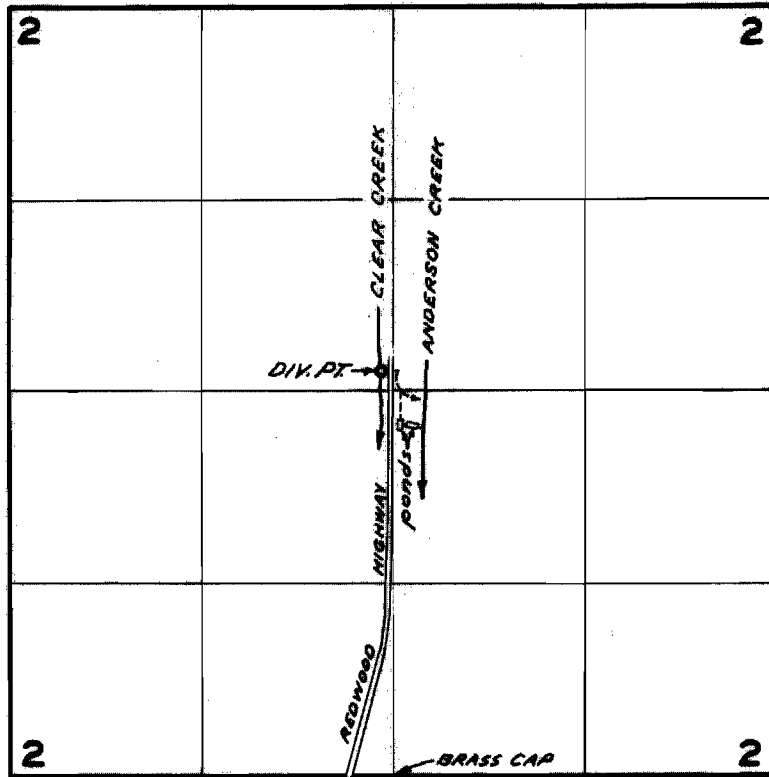

DIV. PT. LOCATED 2780 ft N. & 80 ft W. FROM S. 1/4 COR

FINAL PROOF SURVEY
UNDER

Application No. R-33940 Permit No. R-2366
34020 26830
IN NAME OF

MERVYN WILLIAM HOGAN

Surveyed JUN 23 1966, by R. JACKSON