

T.7S.R.1W.W.M.

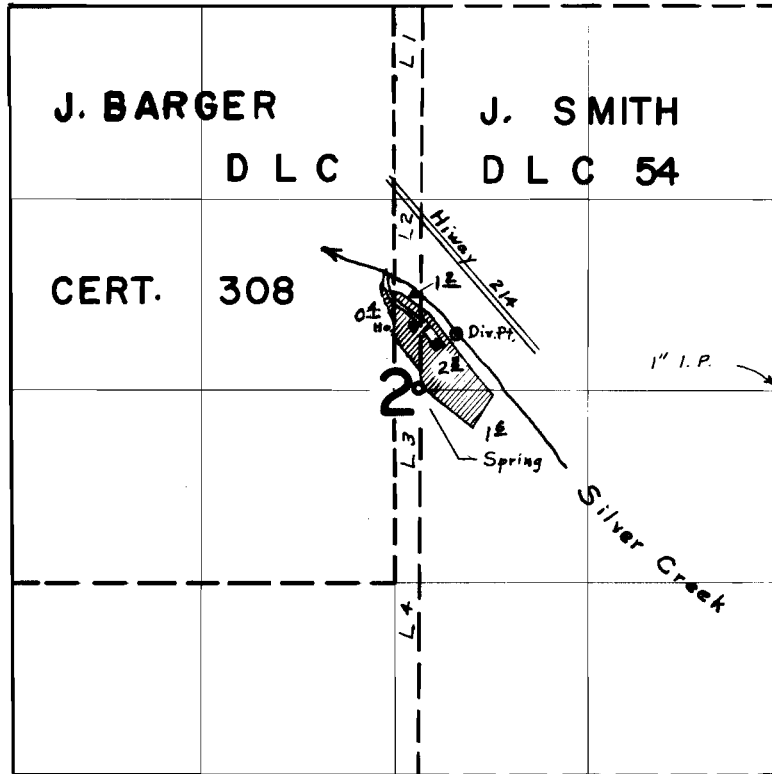

Div. Pt. Located 2225' W. & 380' N.

Spring Located 2470' W. & 5' N.

Both From E. $\frac{1}{4}$ Corner Section 2

FINAL PROOF SURVEY UNDER

Application No. 38933 Permit No. 28914
IN NAME OF

WALLACE JACOBSEN

Surveyed August 12, 1966, by *A. E. Gould*