

T.38S.R.4W.W.M.

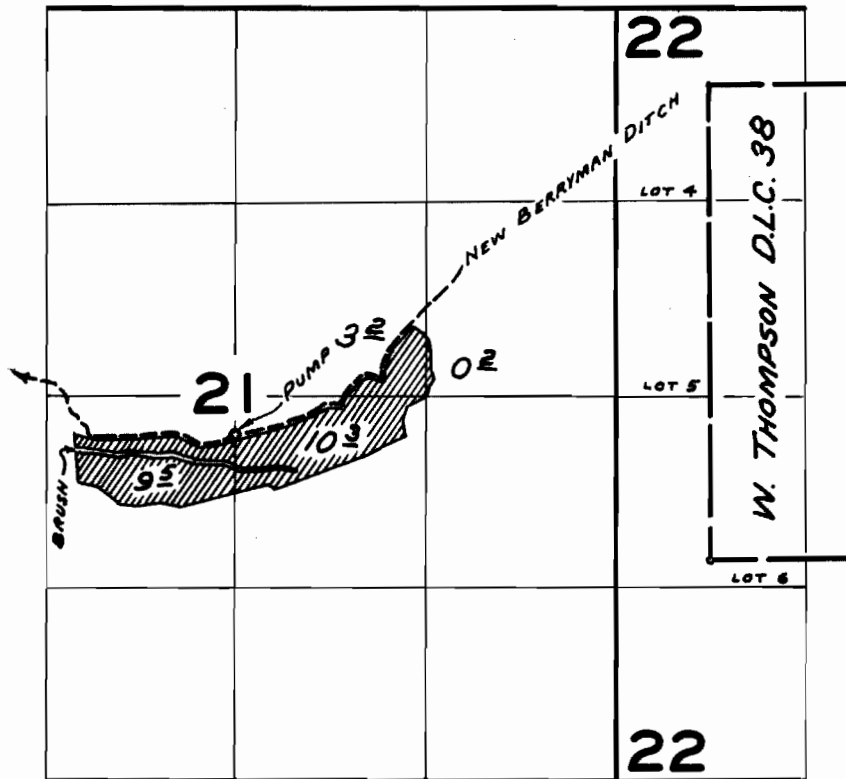

NEW BERRYMAN DITCH DIVERSION POINT LOCATED:
1050' S. AND 500' W. FROM THE NORTH 1/4 COR. SEC. 25
(REFERENCE, TRANSFER NO. S-111)

FINAL PROOF SURVEY
UNDER

Application No. 31987 Permit No. 25242
IN NAME OF

ARION D. CHRISTENSEN

Surveyed JUN 23 1965, by C. GARDNER